

Kreg

Product Catalog



NEW
Klamp Table Lineup
pages 44 - 47

Volume 22 | Fall 2007

NEW
Precision Router Tables
pages 30 - 35

Where Woodworking Comes Together.

Over the past 17 years, Kreg has aimed to be the leader in Pocket-Screw Joinery and an innovative voice in the larger woodworking community. Through a commitment to designing the highest quality tools, providing world-class service and support to our customers, and further developing our top-notch dealer support network, we've done just that. Our philosophy has always been "to provide our customers with more than they expect", and I am proud to say that every product we offer – from the original K2 Kreg Jig® to our new line of Precision Router Tables – continues to maintain these high standards. As you turn the pages of this catalog, please take the opportunity to review some of our new products and see what's been keeping us so busy.

The first group of new products, the Klamp Table™ and full line of Klamp System™ Components, makes assembling Pocket-Screw projects easier than ever before. It was originally designed to be the consumer-level version of our professional Face Framing Table, but we soon discovered it was great for almost any woodworking task. Whether we were sanding, sawing, routing, or joining, it made everything faster and easier than ever before. It's an exciting new product, and we're confident that almost any level of woodworker will find a ton uses for it in their own shop. Turn to page 44 to read more about it.

The second group of products, our all new Precision Router Table and complete Precision Router Line, won't be available until October, but I couldn't wait to share it with you. It includes many unique features which were designed to help our customers get real precision out of their router table, including a breakthrough self-squaring t-square style fence which shares many design similarities to high-end table saw rip fences. The entire table is full of great features, and I hardly do it justice... Turn to page 30 to read more about it.

These new products, and the complete selection of tools in this catalog, continue in the tradition of innovative product development and devotion to the high quality products that Kreg has always stood for. They represent a lot of hard work from the entire Kreg Family, and I am confident they'll meet your high expectations.

Thank you for your interest in Kreg products. Please let us know if we can be of service in the future.

Sincerely,

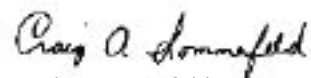

Craig Sommerfeld
Founder/CEO

Kreg Tool Company
Huxley, Iowa 50124
1.800.447.8638 | www.kregtool.com

POCKET-HOLE JIGS

K3 Kreg Jig®	6-7
R3 Kreg Jig®	8-9
Mini Kreg Jig®	10-11
K2 Kreg Jig®	12
K2000 Kreg Jig®	13

POCKET-HOLE MACHINES

The Kreg Machine Advantage	14-15
Foreman Semi-Automatic.....	16-17
DK1100 Single-Spindle.....	18-19
DK3100 Multi-Spindle.....	20-21
DK5100 Panel Boring.....	22-23
Pneumatic Face Frame Table.....	24-25

POCKET-SCREW ACCESSORIES

Self-Tapping Screws.....	26-27
Plugs / Bits / Drivers	28-29

NEW PRECISION ROUTING

Precision Router Table	30-31
Precision Routing Accessories	32-33
Portable Router Table - Benchtop	34-35

PRECISION MEASURING

Precision Miter Gauge	36-37
Precision Band Saw Fence	38-39
Trak & Stop Kit.....	40-41
Precision Measuring Accessories	42-43

NEW CLAMPING SYSTEMS

Klamp Table™	44-45
Klamp System Components	46-47
Right Angle Clamp.....	48
Face Clamps	49

OTHER TOOLS / MISC.

Drawer Slide Mounting Tool	50
Drawer Mounting Brackets	50
Educational Materials	51

* All prices in this catalog are listed in U.S. Dollars

Build with Pocket-Screw Joinery!



"The secret of professional woodworkers is now available to everyone... With Pocket-Screw Joinery, woodworkers of all skill levels can build amazing projects in half the time."

At Kreg, we are very excited about the prospects of bringing the benefits of Pocket-Screw Joinery and the Kreg Jig® to a much larger audience. Because of the strength, speed, and simplicity of the technique, it appeals to many types of woodworkers and individuals with greatly varying skill levels. We are excited to tell the story, and see just how big it can grow.

Visit www.kregtool.com/build to see a brand new video that's focused on explaining the benefits of the technique and the Kreg Jig® to an entirely new audience.

www.kregtool.com/build

Find Your Local Dealer 365 Days a Year!

We're proud of our extensive dealer network and the service they provide. Finding your local Kreg dealer any day of the year is just a click away. Simply type in www.kregtool.com and then select the "Dealer Locator" icon in the upper right hand corner. Enter your zip code and the closest 10 dealers will be posted, including a phone number and a map link showing you the way to their door. As always, we suggest that you call the dealer before you visit to make sure the item you desire is in stock.



Kreg Tool Company
Huxley, Iowa 50124
1.800.447.8638 | www.kregtool.com



Amazingly fast.

When you don't spend your time clamping, waiting for glue to dry, and wading through complicated math, it's amazing how fast your projects can come together! With Pocket-Screw Joinery you can forget all that other stuff and really have fun with your projects. Try Pocket-Screw Joinery today, and learn what its like to finish a project in hours instead of days.



Glue is optional.

It's time-consuming, and it's messy... but best of all, it's completely optional! Unlike mortise and tenons, dowels, and biscuits, the self-tapping screws inside of every Pocket-Screw Joint hold the stock together without any additional help. For the very first time, if you don't want to use glue... you don't have to.



Simple math.

Put the calculators away, and start building already! With Pocket-Screw Joinery, what you see is what you get, and unlike other techniques, there's no need to spend all your time calculating stock-overlaps and dry-fitting individual workpieces. Simple math, fast and accurate results, Pocket-Screw Joinery.



Strength to spare.

It's fast, and it's easy... but it's also amazingly strong! Unlike other joinery methods, Pocket-Screw Joinery utilizes the mechanical advantage of self-tapping steel screws to maximize your joint-strength over the long haul. It's the same strength that professional woodworkers have counted on for years, and now it's available to everyone.



Thousands of uses.

Pocket-Screw Joinery can be used in nearly any situation; so whether you're building a chair, building a cabinet, making repairs to your squeaky floor, working with plywood or beautiful hardwood, Pocket-Screw Joinery is always a perfect fit. Whatever it is you need to build, whatever it is that needs to be repaired, Pocket-Screw Joinery can help.



No commitments.

Don't worry about needing a shop full of clamps or expensive saws and sanders. Pocket-Screw Joinery is amazingly affordable to use, and requires only the simplest of tools. All you need to get started, is a Kreg Jig®, a drill, and a saw. Happy building!



Half the work.

Pocket-Screw Joinery saves you time and frustration at every step... or lack of a step. Don't worry about precisely lining up dowel holes, or spending hours cutting a perfect mortise and tenon; just drill the holes, drive the screws, and move on to the next project. Drill. Drive. Done!



Drill.
Pocket-Holes



Drive.
Self-Tapping Screws



Done!
Perfectly Flush Joints



Framed Cabinets (rear view)



Shelving (rear view)



Frameless Cabinet



Convex and Concave Curves



Edgebanding Shelves
and Counter Tops
(shown upside down)



Aprons / Toe-kicks
(shown upside down)



Leg and Rail



Picture Frames



90° Beveled Corners



Angles



Stairs



Decks

The applications for Pocket-Screw Joinery continue to grow as more and more woodworkers, trim carpenters, and DIY enthusiasts discover how the speed, strength, and simplicity of the technique can benefit them in many different ways.

Cabinetmaking continues to be an area of emphasis as a number of cabinet shops use Pocket-Holes in face frame and frameless cabinet construction alike. Creating solid wood face frames is still the most popular specific application for cabinetmakers while carcass-to-face-frame, drawer box joints, and edgbanding of countertops continue to gain in popularity. For more details into the specifics of each application, check out our **Cabinetmaking Booklet (\$4.99 - Page 51)** that shows simple step-by-step instructions on how to build standard base and wall cabinets. In addition, furniture applications, especially rail-to-leg joints in tables and chairs, benefit from the speed and strength of Pocket-Screw Joinery.

More recently, trim carpenters are finding uses for Pocket-Screw Joinery in a variety of applications on the job site. Our new 114 minute **Trim Carpentry DVD (\$9.99 - Page 51)** features a variety of time-saving trim techniques using Pocket-Screw Joinery to build fireplace mantels, wainscoting, newell posts, stairs, window and door extensions, and more.

In short, we urge you to give Pocket-Screw Joinery a try today. We are confident that you'll soon be looking for more and more ways to use this extraordinary technique in your next woodworking or home improvement project!

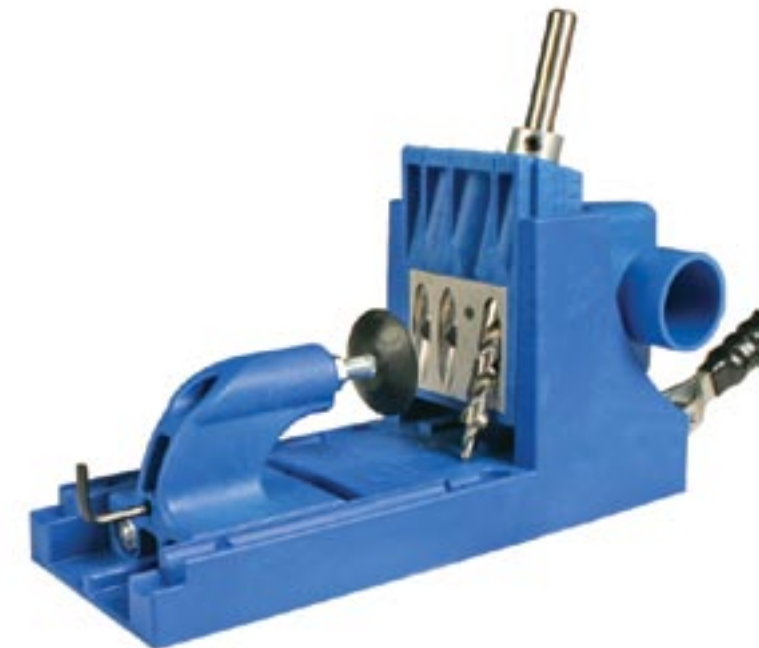

K3 Kreg Jig®

Ultimate Technology. Ultimate Features. The Ultimate Kreg Jig®.

The K3 Kreg Jig® is the ultimate Pocket-Hole Kit on the market and a great choice for any woodworking enthusiast. Whether you're building your very first Pocket-Screw project, or you're in your woodshop twelve hours a day, the Master System is everything for everybody. Between its front-side clamping capabilities, dust-collection shroud, removable drill-guide block, and seemingly endless adjustability, this jig truly has it all! If you're serious about Pocket-Screw Joinery, and even more serious about owning the highest quality tools, look no further than the K3 Kreg Jig® Master System.



Demo Video Available Online

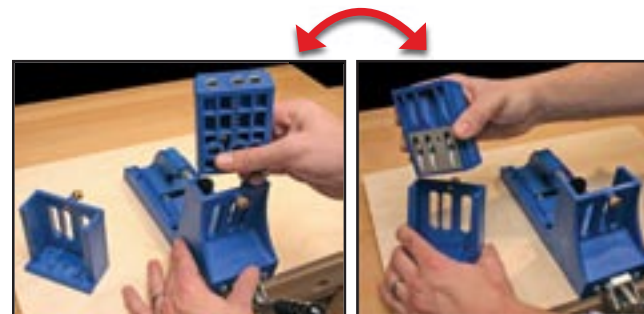

Heading to the job site or working on two projects at once? The K3's drill-guide block removes quickly from the benchtop base for use in the portable base.



The Ultimate Joinery Tool

Two tools, actually. Because the K3 Master System works as both a benchtop and a portable tool. The drill-guide block can be quickly removed from the benchtop base and placed in the portable base for use in the workshop or on the job site. The portable base is designed to work with the dual purpose Premium Face Clamp that both clamps the workpiece to the base while drilling and can then be used for assembly. In addition, the portable base can be screwed down to a board and used in a vertical position, much like the benchtop base.

Interactive Demo Available Online at www.kregtool.com

K3 Kreg Jig® Availability

K3 Kreg Jig® Master System
The ultimate kit for Pocket-Screw Joinery. Includes one drill-guide block, benchtop base, portable base, premium face clamp, material support stop, dust collection shroud, drill bit, depth collar, allen wrench, driver bits, sample screws and carrying case. **ITEM# K3MS \$149⁹⁹**

K3 Kreg Jig® Standard Pack
The perfect kit for the job site. Includes one drill-guide block, portable base, premium face clamp, 3/8" step drill bit, 6" and 3" #2 driver bit, depth collar, allen wrench, sample screws and carrying case. **ITEM# K3SP \$79⁹⁹**

K3 Upgrade Kit
Upgrade your K3 Standard Pack to a complete K3 Master System. Includes benchtop base, material support stop and dust collection shroud. **ITEM# K3UP \$69⁹⁹**

K3 Kreg Jig® Accessories

K3 Drill-Guide Block
Add an extra drill-guide block to your K3. **ITEM# K3DGB \$39⁹⁹**

Material Support Stop
Additional repeatability for your K3. **ITEM# KJSS \$9⁹⁹**

SPECIFICATIONS

- Body Material:** Glass Filled Nylon
- Number of drill-guides:** 3
- Drill-guide spacings:** 9/16", 7/8" and 1-7/16"
- Clamping method:** Toggle Clamp on Benchtop Base
Premium Face Clamp for Portable Base
- Screw centering ability:** 1/2", 5/8", 3/4", 7/8", 1", 1-1/8", 1-1/4", 1-3/8", 1-1/2"

Warranty:



Covered by one or more of the following patents: #4,955,766, #5,676,500, #6,481,937, #6,726,411 Other patents pending.



A



B



C

A DUST COLLECTION

The shroud effortlessly snaps into place on the front of the jig and attaches to any standard 1-1/4" vacuum hose. In addition to a clean shop it also provides faster/easier drill strokes and extends the life of your drill bits.

B MATERIAL SUPPORT STOP

The material support stop can be set at any distance from the jig to repeat the same Pocket-Hole over and over again. The stop can also be swung out of the way to serve as a support for large panels.

C FRONT-SIDE CLAMPING

Exclusive spring-loaded front-side clamping means no more trying to reach around large panels. It puts everything within arm's reach, and also compensates for small thickness variations in your project stock.

R3 Kreg Jig®



Faster. Easier. Simpler. A Kreg Jig® for the rest of us.

The R3 Kreg Jig® is the perfect choice for DIY'ers and anyone new to Pocket-Screw Joinery. Whether you're looking to build your very first bookcase, or just want to make a few simple repairs around the house, the R3 Kreg Jig®'s Easy-Press™ Positioning Sliders and quick-connect Clamp Pad Adapter are there to help you build amazing projects in less time and with greater ease than ever before. If you want to start building your own projects, but don't want to take all day doing it, the R3 Kreg Jig® is just what you've been looking for.



The R3 Kreg Jig® is the perfect tool for anyone new to wood-working. It's an incredibly fast and easy way to build quality projects and make simple repairs around the house.



Simplicity Defined

The R3 Kreg Jig® is the latest in a long line of quality Pocket-Hole Jigs from Kreg. This tool has been designed with some very functional features that deliver outstanding performance at an attractive price.

R3 Kreg Jig® Availability



R3 Kreg Jig®

Kit includes R3 Kreg Jig®, Clamp Pad Adapter, drill bit, depth collar, and allen wrench all contained in a durable plastic carrying case with a built-in depth collar gauge and screw selection chart.

ITEM# R3
\$44⁹⁹

R3 Kreg Jig® Accessories



Premium Face Clamp

Works with the R3's Clamp Pad Adapter. A large, easy-to-grip handle and deep 3-1/4" throat makes this dual-purpose clamp a great addition to your shop. See page 49.

ITEM# PFC
\$19⁹⁹



Self-Tapping Pocket-Hole Screws

Square drive, case hardened, flat head, auger-point screws. Perfect for any Pocket-Hole application. See pages 26-27.

SPECIFICATIONS

- **Body Material:**
Glass Filled Nylon
- **Number of drill-guides:**
2
- **Drill-guide spacings:**
3/4"
- **Clamping method:**
Works with a variety of common clamps. Clamp Pad Adapter accepts any Kreg Face Clamp.
- **Screw centering ability:**
1/2", 5/8", 3/4", 7/8", 1", 1-1/8", 1-1/4", 1-3/8", 1-1/2"

Warranty:

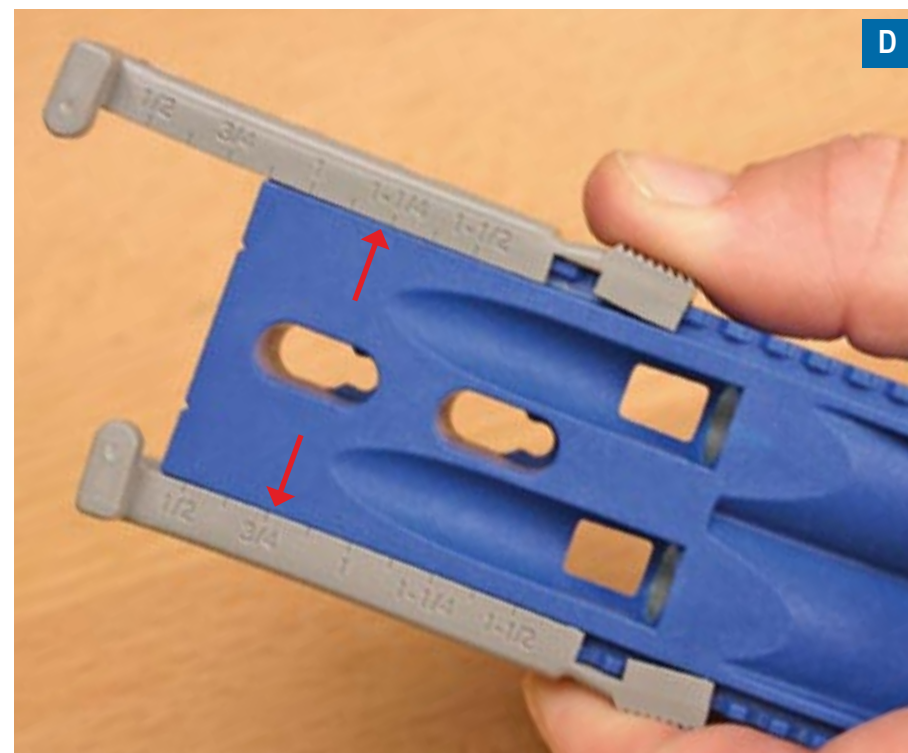
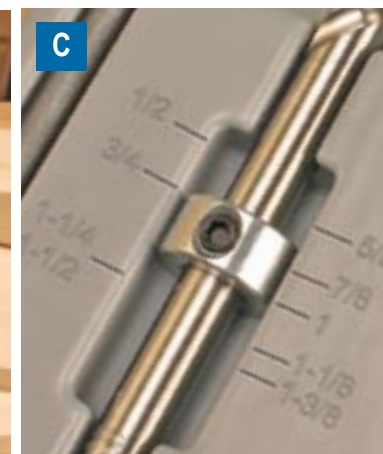

A CLAMP PAD ADAPTER

The R3 is designed to be easily clamped with a standard C-clamp or any of our dual purpose Face Clamps. The Clamp Pad Adapter snaps onto the back of the jig allowing our Face Clamp (not included) to be attached to the jig for faster drilling.

B MATERIAL THICKNESS SETTINGS

From thin drawer boxes and craft projects to stout 2X4's, this jig can join them all. Independent Easy Press™ Positioning Sliders feature 9 separate depth settings, allowing you to easily join materials from 1/2" up to 1-1/2" thick, in 1/8" increments.

C ORGANIZED CARRYING CASE

We've packaged this Kreg Jig® in a durable plastic carrying case to keep things organized and to make sure that you always have the tool, drill bit, and screws on hand to complete your next project. As a bonus, we've molded a depth collar gauge into the case for a handy reference.

D EASY-PRESS™ POSITIONING SLIDERS

Simply depress the button on the side of the jig and move the sliders so that your material thickness is aligned with the arrow on the jig body (shown in red) to set your drilling depth.

Mini Kreg Jig®



Little Tool. Big Impact.

The Mini Kreg Jig® is an amazing repair jig and an exceptionally handy addition to any Pocket-Screw collection. Whether you're building a simple project from scratch or crawling under a table to make a quick repair, the Mini's small design lets you work in the tightest of places. While it may not be the most heavily used Pocket-Hole Jig you own, in the right situation, it just might be the most appreciated.

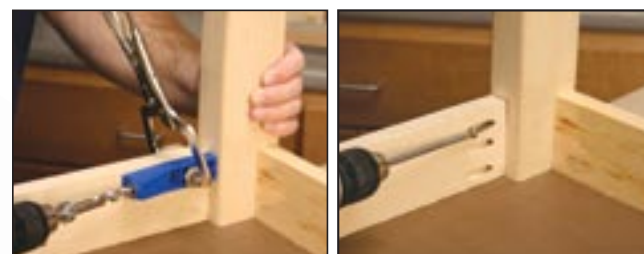

Clamp the Mini Kreg Jig® to the loose table rail. Use a self-tapping screw to pull the pieces together and anchor them tightly.



The Perfect Tool For Repairs

Got a wobbly chair or table? You can pry it all apart, glue it, clamp it, reassemble it and hope it holds up, or you can tighten it in a snap with the Mini Kreg Jig®. Small enough to fit just about anywhere, you can use it to fix chair runners, secure table rails to legs and more.

Mini Kreg Jig® Availability



Mini Kreg Jig® Kit

The perfect repair jig. This kit includes the Mini Kreg Jig®, stepped drill bit, depth collar and allen wrench.

ITEM# MKJKIT
\$21⁹⁹



Mini Kreg Jig®

An extra Mini Kreg Jig® is always nice to have around the shop. Features a hardened steel drill guide with a lifetime warranty.

ITEM# MKJ
\$9⁹⁹

Mini Kreg Jig® Accessories



Premium Face Clamp

Rugged dual-purpose clamp features a large easy-to-grip handle and deep 3-1/4" throat. See Page 49.

ITEM# PFC
\$19⁹⁹



Pocket-Hole Plugs

Perfect for concealing or decoratively accenting any Kreg Pocket-Hole. Available in 7 solid-wood species and 5 plastic colors. See Pages 28-29.

SPECIFICATIONS

- **Body Material:**
Glass Filled Nylon
- **Number of drill-guides:**
1
- **Drill-guide spacings:**
N/A
- **Clamping method:**
Works with a variety of common clamps or any Kreg Face Clamp.
- **Screw centering ability:**
1/2" to Unlimited
- **Warranty:**



A WOOD-CHIP RELIEF HOLE

With the Mini Kreg Jig®, you don't have to keep removing the drill bit to clean out the hole. A wood-chip relief hole in the jig gives the removed material a place to go, so you can keep on drilling.

B HARDENED STEEL DRILL-GUIDE

Precise Pocket-Holes are a guarantee with the Mini Kreg Jig® because the hardened steel drill guide keeps the bit from deflecting as it hits the workpiece.

C PLUG SETTING FEATURE

If you decide to conceal or decoratively accent your Pocket-Holes with our solid wood Pocket-Hole Plugs, the Mini's plug setting feature is the fastest, easiest, and safest way to do so.

D UNLIMITED MATERIAL THICKNESS

The Mini Kreg Jig® is the only Kreg Jig® that does not include a positioning fence. This fenceless design allows you to make precise angle and stock depth adjustments as needed, making the Mini the most 'positionable' jig available.

K2 Kreg Jig®



Where it all began...

Way back in the late 80's, this is the jig that started it all. Designed as a pure cabinetmaking tool, the rigid, aluminum bodied K2 Kreg Jig® will stand up to years of use and abuse. This tool is designed to primarily work with 3/4" thick material.



K2000 Kreg Jig® Pocket-Hole System



A Great Choice for Common Materials

The Kreg Jig® K2000 Pocket-Hole System™ is the second-generation Kreg Jig® introduced back in 2000. It's a good choice for woodworkers who primarily work with materials that are 1/2", 3/4", and 1-1/2" thick. It's a complete kit with everything you need to get started right out of the box.



A

A SOLID ALUMINUM BODY

The cast aluminum two-piece frame is machined for precision accuracy, won't rust, and is constructed for long-term use. The jig can be mounted to a workbench or clamped as needed.

B TOGGLE CLAMP

The fast action clamp of the K2 Kreg Jig® quickly adjusts to the thickness of the wood with the turn of a screw, and applies just the right amount of pressure to hold the workpiece in place.

C PERFECT SPACING FOR RAILS

Today's most common cabinet rail widths are easily covered with the 7/8" on-center drill guide spacing of the K2. Just clamp your workpiece and drill both holes.

D HARDENED STEEL DRILL-GUIDES

The lifetime guarantee says it all. You can count on quality tear-out free Pocket-Holes every time, because the hardened steel drill-guides are built to last.



C

D

A QUICK THICKNESS ADJUSTMENTS

Just remove the bolt, add the correct spacing block, and replace the bolt for speedy positioning.

B SUPPORT WINGS

Position panels and longer boards "wobble-free" thanks to support wings that keep your Pocket-Holes perpendicular to the edge of your workpiece.

C 3 HOLE DRILL-GUIDE DESIGN

The patented 3 hole drill-guide design gives you Pocket-Holes exactly where you need them for narrow, wide, and wider stock.

D HARDENED STEEL DRILL GUIDES

The lifetime guarantee says it all. You can count on quality tear-out free Pocket-Holes every time, because the hardened steel drill guides are built to last.

K2 Kreg Jig® Availability



K2 Kreg Jig®

The "original" Kreg Jig®. Includes stepped drill bit, depth collar and allen wrench.

ITEM# K2
\$99⁹⁹

K2 Kreg Jig® Accessories



Premium Face Clamp

Large, easy-to-grip handle and deep 3-1/4" throat make this clamp a great addition to your shop. See Page 49.

ITEM# PFC
\$19⁹⁹

SPECIFICATIONS

• **Body Material:**
Aluminum

• **Number of drill-guides:**
2

• **Drill-guide spacings:**
7/8"

• **Clamping method:**
Toggle Clamp

• **Screw centering ability:**
1/2" and 3/4"
1/2" requires use of a shim

• **Warranty:**



K2000 Kreg Jig® Availability



Kreg Jig® K2000 Pocket Hole System

Includes K2000 Kreg Jig®, Standard Face Clamp, support wings, stepped drill bit, 6" driver bit, depth collar and allen wrench.

ITEM# KJK2K
\$109⁹⁹

K2000 Kreg Jig® Accessories



Self-Tapping Pocket-Hole Screws

Square drive, case hardened, flat head, auger point screws. Perfect for any Pocket-Hole application. See Pages 26-27.

SPECIFICATIONS

• **Body Material:**
Glass Filled Nylon

• **Number of drill guides:**
3

• **Drill guide spacings:**
9/16", 7/8" & 1-7/16"

• **Clamping method:**
Toggle Clamp

• **Screw centering ability:**
1/2", 3/4" & 1-1/2"

• **Warranty:**



The Kreg Pocket-Hole Machine Advantage

When it comes to production Pocket-Holes, we've got you covered. We offer the widest selection of industrial Pocket-Hole Machines on the market. Semi-automatic, fully-automatic, single-spindle or multi-spindle, choose an option that fits your production schedule and budget. A demonstration DVD is available upon request.



Fast

...imes of 2 seconds
...and we have
...es that drill up to
...per cycle! Fast,
...t and built for
...eed production.



Durable

Unlike other drilling machines, Kreg machines use a hardened steel drill-guide that supports the drill bit all the way into the workpiece, prolonging drill bit life and improving the cut quality of each Pocket-Hole.



Quiet

No need to bring your earplugs... Kreg machines (electric and pneumatic) are the quietest on the market. Now that's something everyone in the shop can appreciate.



Reliable

All Kreg Pocket-Hole Machines are TRUE production machines featuring high-quality industrial motors that are built to run all day, every day, in high volume production environments. Our unique design minimizes the stress on moving parts and eliminates failure prone parts.



Repeatable

Kreg machines feature unique Swing Stops that allow your stock to be positioned in a repeatable fashion and Pocket-Holes to be easily duplicated in the same location across cabinet rails. A Swing Stop can be quickly swung out of the way – and bypassed completely – by simply pushing your stock into its face.



Quick

Don't let bit changes slow you down! All of our machines feature a simple and straightforward design which lets you switch bits in 60 seconds or less. Time IS money after all.



Adjustable

Whether you're working with 1/2" wide stock or 4" wide stock, 1/2" material or 2x4s, we've got the machine to handle it. All Kreg Pocket-Hole Machines make it easy to adjust for your specific stock in just a few seconds.



	Foreman DB55	Foreman DB110	Single-Spindle DK1100 TP	Single-Spindle DK1100 FP	Single-Spindle DK1100 FE	Muti-Spindle DK3100	Panel Boring DK5100
Suggested MSRP:	\$849	\$849	\$2,699	\$2,899	\$2,899	\$3,699	\$7,999
Motor Type:	Pneumatic, 3/4 hp	Electric, 3/4 hp 110 V Single Phase	Pneumatic, 1-1/4 hp	Pneumatic, 1-1/4 hp	Electric, 1-1/2 hp 110 V Single Phase	Electric, 1-1/2 hp 110 V Single Phase	5 Pneumatic, 3/4 hp
Drill Bits:	DKDB drill bit (3/8" shank dia. 3/16 pilot 1/2" long)	DKDB drill bit (3/8" shank dia. 3/16 pilot 1/2" long)	DKDB drill bit (3/8" shank dia. 3/16 pilot 1/2" long)	DKDB drill bit (3/8" shank dia. 3/16 pilot 1/2" long)	DKDB drill bit (3/8" shank dia. 3/16 pilot 1/2" long)	2 DKDB drill bits, 1 LH-DKDB left hand (3/8" shank dia. 3/16 pilot 1/2" long)	DKDB drill bit (3/8" shank dia. 3/16 pilot 1/2" long)
CFM Rating:	6 cfm at 50% duty cycle (120 psi)	N/A	8 cfm at 50% duty cycle (120 psi)	8 cfm at 50% duty cycle (120 psi)	1 cfm for clamp cylinder (90 psi min.)	1 cfm for clamp cylinder (90 psi min.)	20 cfm at 50% duty cycle (120 psi)
Cycle Time:	1 second cycle time	1 second cycle time	1 second cycle time	1 second cycle time	1 second cycle time	1 second cycle time	2 second cycle time
Material Clamping Capacity	1-1/2"	1-1/2"	4"	4"	4"	4"	1-3/4"
Hole Centering Capability	1/2" material to 1-1/2" material	1/2" material to 1-1/2" material	1/2" material to 1-1/2" material	1/2" material to 1-1/2" material	1/2" material to 1-1/2" material	1/2" material to 1-1/2" material	1/2" material to 3/4" material
Weight	40 lbs.	40 lbs.	77 lbs.	138 lbs.	176 lbs.	179 lbs.	350 lbs.
Dimensions	20" H x 14" W x 23" D (Tabletop height of 7")	27" H x 14" W x 23" D (Tabletop height of 7")	19" H x 24" W x 24" D (Tabletop height of 8")	50" H x 24" W x 24" D (Tabletop height of 40")	50" H x 24" W x 24" D (Tabletop height of 40")	50" H x 24" W x 24" D (Tabletop height of 40")	50" H x 36" W x 24" D (Tabletop height of 40")
On-Center Spindle Spacings	N/A	N/A	N/A	N/A	N/A	3/4", 1", 1-3/4"	6"

The Foreman



Demo Video Available

Single-Step Pocket-Holes. A Small Shop's Dream.

If your production needs have outpaced our manual jigs, but you're not quite ready for a heavy-duty production machine, the Foreman is just what the contractor ordered. It features single-step operation for simplicity and speed, swing stops for production repeatability, and a durable design which is perfect for any jobsite or small shop.



The Foreman is available in two individual models – Pneumatic and Electric – which lets you choose the way you work.

Simply Smart

The operation of the Foreman couldn't be simpler – one pull, one perfect Pocket-Hole. Other Pocket-Hole Machines require you to take the time to clamp your workpiece manually, but the hands-free clamping of the Foreman saves you that step, greatly increasing productivity.



Foreman Availability



Electric Foreman

Take your work on the road. This Foreman features a rugged 3/4 hp, single-phase electric motor. Anywhere you've got a standard 110V outlet, you've got high speed Pocket-Holes, on demand.

ITEM# DB110
\$849⁰⁰



Pneumatic Foreman

Got air? This Foreman features an industrial-grade 3/4 hp pneumatic motor capable of the same Pocket-Hole power as the electric version. Requires a compressor capable of producing 6cfm at 120 psi.

ITEM# DB55
\$849⁰⁰

Pocket-Hole Machine Accessories



Cobalt Machine Drill Bit

Cobalt steel drill bit for all Kreg machines. Designed for production drilling in high heat conditions.

ITEM# DKDB
\$29⁹⁹

SPECIFICATIONS

- **Motor:**
Electric: 3/4 hp 110 V single phase
Pneumatic: 3/4 hp
- **Drill Bits:**
DKDB Drill Bit (3/8" Shank Dia. 3/16" Pilot, 1/2" long)
- **CFM Rating:**
Electric: N/A
Pneumatic: 6 cfm clamp cylinder (120 psi min)
- **Cycle Time:**
1 second
- **Material Clamping Capacity:**
1-1/2"
- **Hole Centering Capability:**
1/2" material to 1-1/2" material
- **Weight:**
40 lbs.
- **Dimensions:**
Electric: 27" H x 14" W x 23" D (7" table height)
Pneumatic: 20" H x 14" W x 23" D (7" table height)
- **Warranty:**
1 Year



A B



C

A RELIABLE, ONE STEP DRILLING

Just position the wood and pull the lever. The automatic clamp secures the workpiece and the 3/8" stepped bit drills the Pocket-Hole in one smooth operation. In just seconds, you're ready to drill another workpiece.

B MATERIALS UP TO 1-1/2" THICK

The Foreman quickly adjusts from the topside of the machine to position a screw in material from 1/2" up to 1-1/2" thick. Drill everything from drawer boxes to face frames and deck material using this one machine.

C SWING STOPS

The one-step drilling isn't the only thing that speeds production. The material positioning stops allow you to place Pocket-Holes precisely across a workpiece, yet swing out of the way when not needed, such as drilling across the length of a panel.



DK1100 Pro Series

Single-Spindle Machines



Demo Video Available

Fast. Quiet. Reliable.

The Production Pocket-Hole Standard.

Unlike some other fully-automatic Pocket-Hole Machines in this class, the DK1100 series (and all of our machines) are built with true industrial-grade motors that provide the power to run day after day – quickly, quietly, and reliably – in even the most high-production environments. For most shops, this translates into previously unheard of productivity and efficiency. Something we could all use more of.



The DK1100 is available in three models – one Electric and two Pneumatic – which fit the specific needs of almost any production shop.



It Works For You

The DK1100 series of machines are the standard in the industry for drilling a single Pocket-Hole at a time. We've packed a ton of functional features into these machines that really set them apart from the competition. Choose from electric or pneumatic powered, free-standing or bench-mounted to fit the way you build.

DK1100 Single-Spindle Availability



DK1100 FE

Add real productivity and efficiency to your shop with the 'Production Pocket-Hole Standard.' This model works with any standard 110V outlet and features a strong 1-1/2 hp electric motor, single-spindle simplicity, and cycle times of less than one second.



ITEM# DK1100 FE
\$2,899



DK1100 FP

Already set up for pneumatic? This model features an industrial-grade 1-1/4 hp pneumatic motor capable of the same Pocket-Hole productivity as the electric version. Requires a compressor able to produce 8cfm at 120 psi. (50% duty cycle)

ITEM# DK1100 FP
\$2,899



DK1100 TP

This model is identical to the DK1100 FP, just in a much smaller frame. It features a table height of 8", making it easy to build into your workbench or relocate from time to time. Requires a compressor able to produce 8cfm at 120 psi. (50% duty cycle)

ITEM# DK1100 TP
\$2,699

SPECIFICATIONS

- Motor:**
 Pneumatic Models: 1-1/2 hp
 Electric Model: 1-1/2 hp 110 V single phase
- Drill Bits:**
 DKDB Drill Bit (3/8" Shank Dia. 3/16" Pilot, 1/2" long)
- CFM Rating:**
 TP & FP: 8 cfm at 50% Duty Cycle (120 psi min)
 FE: 1 cfm clamp cylinder (90 psi min)
- Cycle Time:**
 1 second cycle time
- Material Clamping Capacity:**
 4"
- Hole Centering Capability:**
 1/2" material to 1-1/2" material
- Weight:**
 TP: 77 lbs., FP: 138 lbs., FE: 176 lbs.
- Dimensions:**
 TP: 19" H x 24" W x 24" D (8" Table Height)
 FP: 50" H x 24" W x 24" D (40" Table Height)
 FE: 50" H x 24" W x 24" D (40" Table Height)
- Warranty:**
 5 Year Limited Warranty

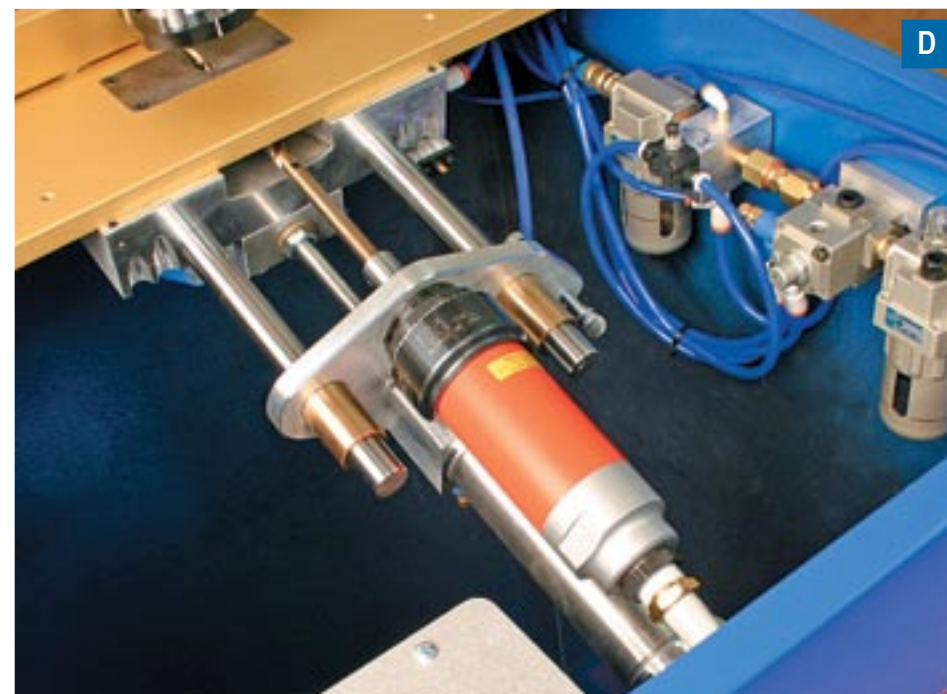

A CONVENIENT SWING STOPS

Quickly position two Pocket-Holes across rails of various widths by placing it against one stop, drilling the hole, then repeating with the rail against the other stop. For drilling Pocket-Holes in panels, the stops simply swing out of the way.

B ADJUSTABLE FENCE

Adjustments couldn't be easier as the fence adjusts right from the topside of the machine to let you center a screw in 1/2" to 1-1/2" thick materials. The hold down clamp also adjusts to allow materials up to 4" thick to be drilled.

C QUICK DRILL BIT CHANGES

Changing drill bits is a quick and simple process. Simply loosen the collet with the provided allen wrench, replace with a new bit and you are back in production in less than 60 seconds.

D MOTORS BUILT TO LAST

The industrial grade motors used in Kreg machines are built for long lasting service. Kreg machines are also designed to minimize stress on moving parts, greatly reducing the likelihood of failure.

DK3100 Pro Series Multi-Spindle



Demo Video
Available

The same Face-Frames. Twice as fast.

If you're looking for the ultimate machine to build face-frames, look no further. The multi-spindle DK3100 contains three spindles which allow you to drill TWO Pocket Holes across rails of varying widths in just one machine cycle – something that no other Pocket-Hole machine on the market can do. Best of all, it can also be quickly changed to drill a single Pocket-Hole, like our DK1100 series, by simply removing a drill bit. In short, if you're serious about face frame production, the DK3100 is the machine that will deliver real performance to your shop and profits to your bottom line.

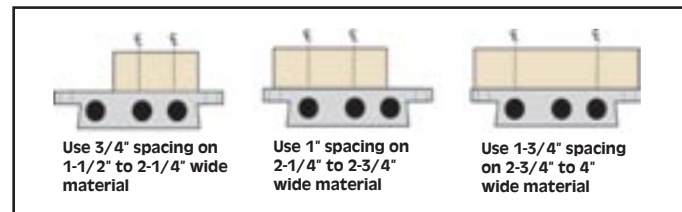

The DK3100 not only drills two Pocket-Holes in one cycle, it also gives you options for spacing the holes. You can set the drill spindles at 3/4", 1" and 1-3/4" on center, perfect for today's most common rail widths.

Pocket-Holes Twice as Fast!

Multiple spindles give you the option of three different hole spacings to fit today's most common face-frame widths. If you would prefer to drill only one Pocket-Hole, no problem, just remove a drill bit and you get the equivalent of our DK1100 single-spindle machine. Only Kreg offers you the option of one or two Pocket-Holes at a time and your choice of three different on-center hole spacings **IN THE SAME MACHINE!**

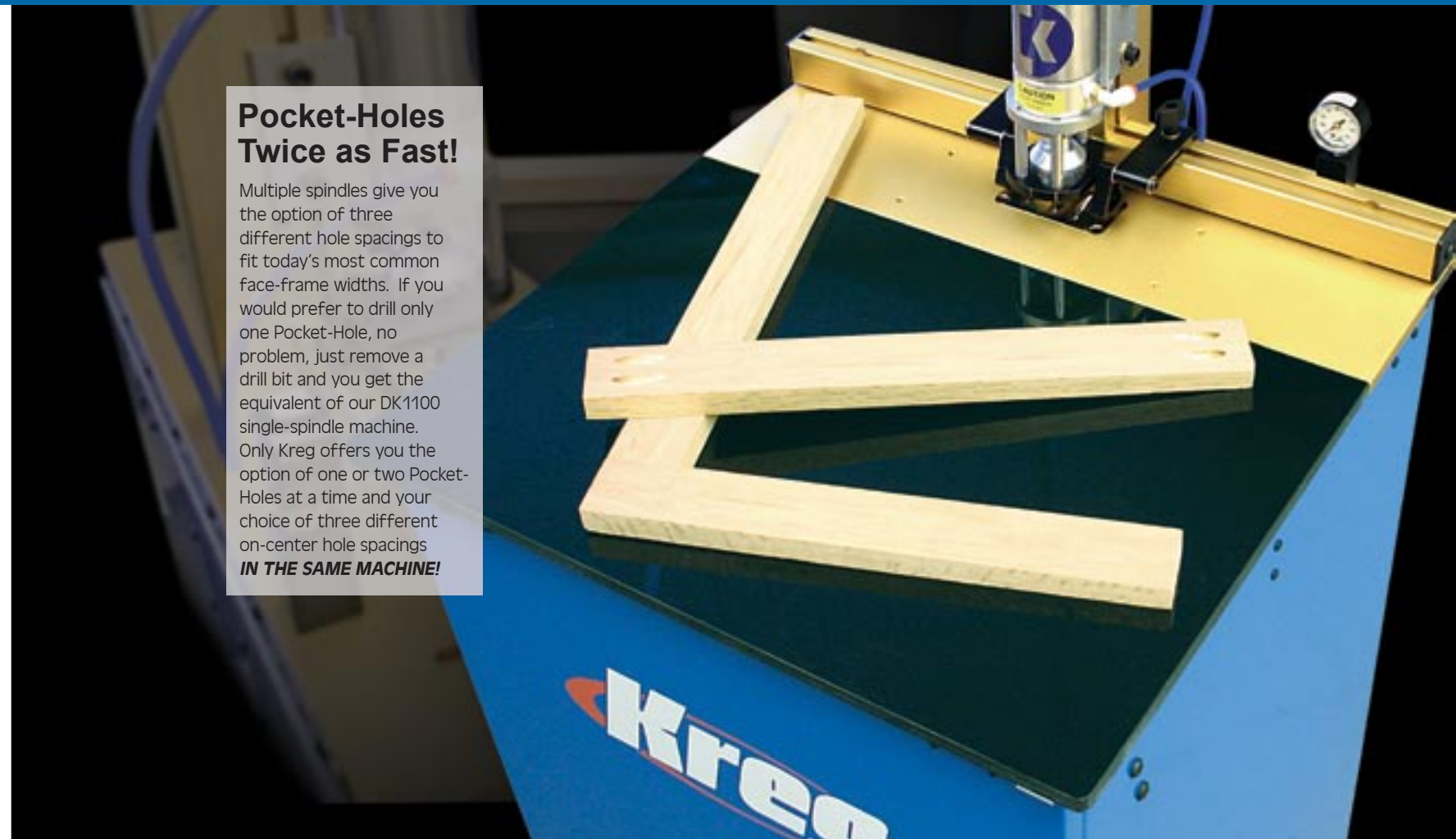

DK3100 Multi-Spindle Availability



DK3100 Multi-Spindle

Twice the Pocket-Holes. Twice the Productivity. The DK3100 features a strong 110V 1-1/2" hp electric motor which runs two separate spindles and drills two perfect Pocket-Holes in less than one second.

ITEM# DK3100

\$3,699⁹⁹

Pocket-Hole Machine Accessories



DKDB drill bit
3/8" cobalt steel drill bit

ITEM# DKDB

\$29⁹⁹



LH-DKDB drill bit
Left handed 3/8" cobalt steel drill bit for DK3100

ITEM# LH-DKDB

\$34⁹⁹

SPECIFICATIONS

- **Motor:** Electric, 1-1/2 hp 110 V single phase
- **Drill Bits:** DKDB Drill Bit (3/8" Shank Dia. 3/16" Pilot, 1/2" long)
- **CFM Rating:** 1 cfm clamp cylinder (90 psi)
- **Cycle Time:** 1 second cycle time
- **Material Clamping Capacity:** 4"
- **Hole Centering Capability:** 1/2" material to 1-1/2" material
- **Weight:** 176 lbs.
- **Dimensions:** 50" H x 24" W x 24" D (40" Table Height)
- **On-Center Spindle-Spacings:** 3/4", 1", 1-1/2"
- **Warranty:** 5 Year Limited Warranty



A EASY SETUP

The lift-off top gives you direct access to the drill bits. A simple turn of an allen wrench in the drill bit collets is all it takes to change bits. In less than a minute, you can change to any of the three settings or set up the DK3100 for single-spindle drilling.

B ONE SECOND CYCLE TIMES

Two Pocket-Holes in one second? It's not a dream, it's reality with the DK3100. The one-touch foot pedal fires the spindle to make two perfect Pocket-Holes in one second.

C DURABLE

The DK3100 uses a hardened steel drill guide that supports the drill bits all the way into the workpiece, prolonging drill bit life and improving the cut quality of the Pocket-Hole.

DK5100 Pro Series Panel Boring Machine

One Machine Cycle. Five Pocket-Holes.

Five industrial-grade motors, five individually activated clamping cylinders, and five durable drill spindles; all in one amazing machine. The DK5100 makes drilling multiple Pocket-Holes across cabinet sides, shelving, stairs, and window/door extensions, easier than ever before. In the right situation, it can beat the bottle-neck that's slowing down your shop and significantly improve your bottom line. Real performance. Real results. The DK5100.



Don't let bit changes slow you down. The simple and straight forward design of the 5100 – and all of our machines – lets you make easy bit changes in 60 seconds or less.

**Demo Video
Available**



Increase Your Shop's Output

This machine is built for the shop that has a specific repetitive application that screams for increased productivity. The time saved by drilling up to five Pocket-Holes at once is truly dramatic and will allow you to reallocate resources to areas of your shop that need more attention.

DK5100 Multi-Spindle Availability

DK5100 Panel Boring

Production panels just got faster. The DK5100 features 5 industrial-grade 3/4 hp pneumatic motors which power 5 individual drilling spindles. Requires a compressor able to produce 20 cfm at 120 psi. (50% duty cycle)



ITEM# DK5100
\$7,999⁹⁹

Pocket-Hole Machine Accessories

DKDB drill bit

3/8" cobalt steel drill bit

ITEM# DKDB
\$29⁹⁹



Self-Tapping Pocket-Hole Screws

Square drive, case hardened, flat head, auger-point screws. Perfect for any Pocket-Hole application. See Pages 26-27.



SPECIFICATIONS

- **Motor:** Pneumatic, (5) 3/4 hp motors
- **Drill Bits:** DKDB Drill Bit (3/8" Shank Dia. 3/16" Pilot, 1/2" long)
- **CFM Rating:** 20 cfm at 50% Duty Cycle (120 psi)
- **Cycle Time:** 2 second cycle time
- **Material Clamping Capacity:** 1-3/4"
- **Hole Centering Capability:** 1/2" material to 3/4" material
- **Weight:** 350 lbs.
- **Dimensions:** 50" H x 36" W x 24" D (40" Table Height)
- **On-Center Spindle-Spacings:** 6"
- **Warranty:** 5 Year Limited Warranty



A INDIVIDUAL CONTROL

Each of the five spindles is controlled with an on/off switch located on each clamping tower, giving you instant control of every spindle. Drill with all five spindles at once or turn a couple off to best meet the needs of your project.

B 5 POCKET-HOLES, 1 CYCLE

The DK5100's five spindles are spaced 6" on-center, the perfect spacing for many panel applications. A simple tap of the foot pedal will create five uniform Pocket-Holes in less than 2 seconds. That's productivity.

C PNEUMATIC POWER

All five drill spindles are driven by industrial grade pneumatic motors that are designed to provide you with plenty of drilling power, panel after panel, year after year.

Face Framing Table



Demo Video Available

Save Time. Save Your Back.

Assembling perfectly flush face-frames is a breeze with our pneumatic Framing Table. Assembly is quick, and since the flush assembly reduces and often eliminates the need for sanding, you'll save even more time and money. Best of all, the Framing Table stands at a 30 degree angle, so it uses less floor space than a flat table and saves your back by allowing you to work upright rather than hunched over.

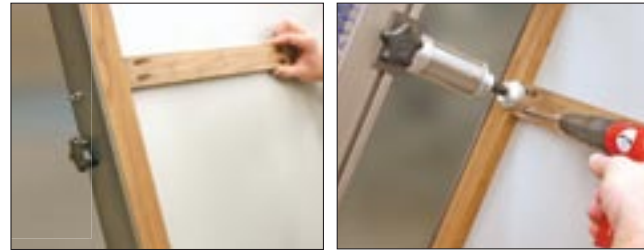

Flush face frames made easy. Align stile and rail along squaring fence. Adjust clamp cylinder and secure joint line. Drive self-tapping screw.

Perfectly Square. Perfectly Flush.

Fast assembly is great. Fast, accurate assembly that virtually eliminates sanding is even better. With the Framing Table, you'll get it all. It begins with the squaring fence for a perfectly square start. The pneumatic clamping cylinders hold your frame flush against the sturdy surface, helping to eliminate imperfections in the assembly so you'll rarely — if ever — need to finish sand your frame.

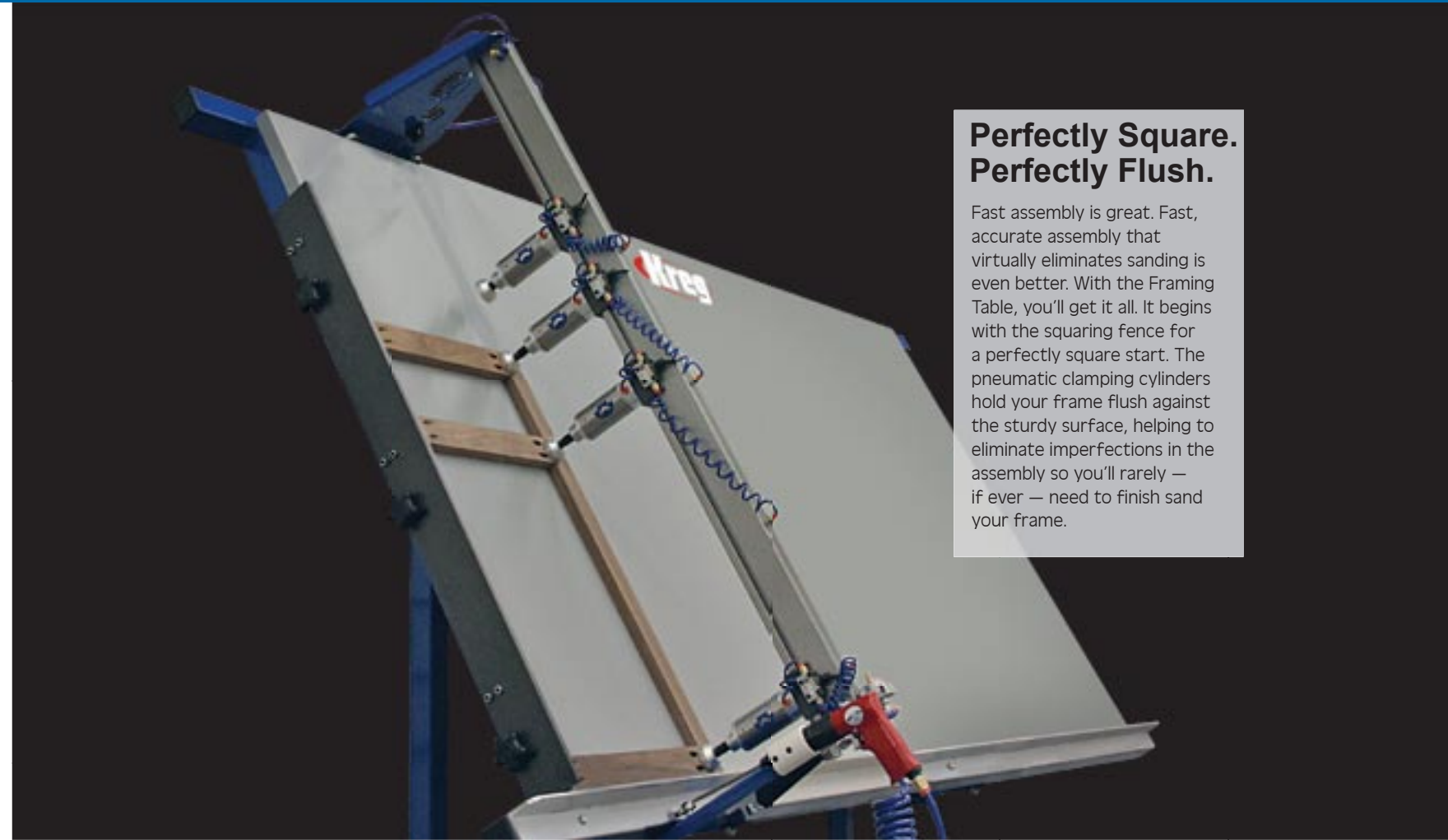

Face Framing Table Availability



Face Framing Table
Large, 4'x8' table surface with 4 independently controlled pneumatic clamping cylinders.

ITEM# KFT4X8
\$2,999⁹⁹

Face Framing Table Accessories



Pneumatic Screwgun & 8' Polyurethane Coil Hose

Industrial-grade reversible pneumatic screwgun with quick-change chuck and 8' Polyurethane coil hose with 1/4" NPT fittings and single swivel-fitting. Connects directly to pneumatic outlet on framing table.

ITEM# CT6066
\$104⁹⁹

SPECIFICATIONS

- **Table Dimensions:**
76" H x 110" W x 30" D
- **Angle:**
30° from vertical
- **Weight:**
350 lbs.
- **Retractable Squaring Fence:**
Retracts out of the way for frames longer than 8'.
- **Work Surface:**
4'x8' melamine, 1-1/8" thick
- **Clamping:**
Four high-quality clamping cylinders can be independently controlled. Activate one at a time or all at once by a master switch.
- **Accessories:**
Add our Pneumatic Screwgun and 8' Coil Hose

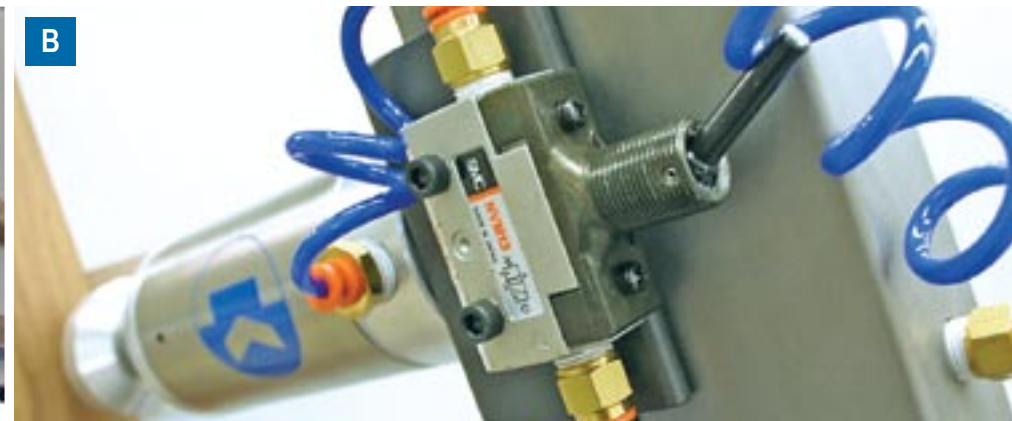
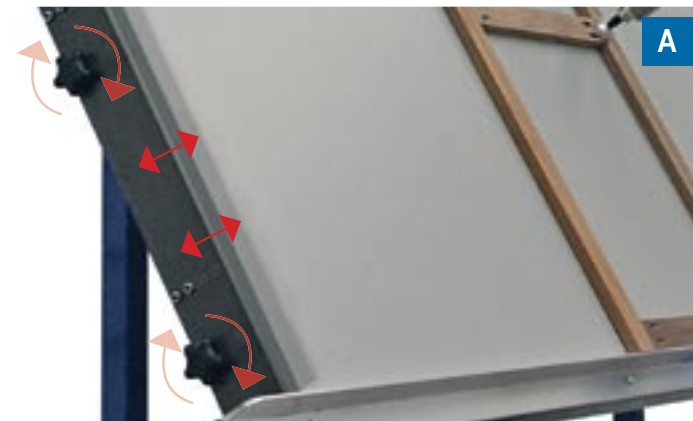

A RETRACTABLE SQUARING FENCE

The aluminum squaring fence on the left side of the table retracts out of the way to accommodate frames longer than 8'. Just begin your frame with the squaring fence up, then retract the fence as needed.

B CUSTOMIZED SETUP

Each clamping cylinder can be independently controlled, so you can actuate each cylinder individually or activate them all at once with a master switch located at the bottom of the clamping arm.

C POWERFUL CLAMPING

The four high-quality clamping cylinders apply tremendous pressure on the joint line to maintain a flush assembly. The clamping arm rolls easily on roller bearings and each cylinder glides smoothly along the arm for perfect positioning.

Self-Tapping Screws

Our self-tapping screws are specially designed for Pocket-Screw Joinery. They feature a self-tapping auger point that eliminates pre-drilling and a flat head that seats flushly in the bottom of the Pocket-Hole. All of our screws utilize a #2 square drive recess. The deep recess of the square drive provides positive driver engagement to reduce cam-out. Like every Kreg product, our screws are manufactured from the highest quality materials. To manufacture a virtually unbreakable screw, industrial quality steel is first case-hardened and then coated with a dri-lube finish which reduces driving torque and gives them their bronze appearance.

Choosing the right screw...

We offer three thread types, two head styles and four different lengths to handle all pocket hole applications. Find the right screw using the information below.

Screw Length

Choosing the correct screw length depends on the size of the material you are working with. Using the correct screw will eliminate the possibility of break-through and provide optimum hold-strength on the joint.

Find your correct screw length: (all screw lengths assume joining stock of equal thicknesses)

- 1/2" Stock: 1" Screw
- 3/4" Stock: 1-1/4" Screw
- 1-1/2" Stock: 2-1/2" Screw

Thread Type

Choosing the correct thread type depends on the species of wood you are working with. Using the correct screw will ensure maximum hold pressure and dramatically strengthen each joint.

Coarse Thread: Soft Woods and Composites Plywood, MDF, Pine, etc.

Fine Thread: Hard Woods Oak, Maple, Walnut, Cherry, Hickory, etc.

Hi-Lo: For use as a general purpose screw and with medium hardwoods such as Poplar.

Head Style

Choosing the correct head style depends on the species and size of material you're working with.

The Maxi-Loc™ washer-head screw is the most popular style and provides a large amount of surface area on the head of the screw, helping to ensure the strongest possible hold and keeping it from being overdriven in soft woods such as plywood or pine.

Pan-Head screws feature a slightly smaller size – in both shank diameter and head size – which makes them the preferred choice for extremely hard woods. This smaller head also guarantees that the screw will set below the surface of the wood when joining 1/2" stock.



Self-Tapping Screws Availability

Maxi-Loc™ Fine

Maxi-Loc™ Fine Thread - This is the standard screw for hardwood to hardwood applications. Large washer head provides a superior hold in the bottom of the pocket.

Part #	Description	100	500	1,000	5,000
#SML-F125	#7, fine thread, 1-1/4"	\$4.25	\$15.99	\$23.99	\$69.99
#SML-F150	#7, fine thread, 1-1/2"	\$4.49	\$16.99	\$24.99	\$74.99

Maxi-Loc™ Coarse

Maxi-Loc™ Coarse Thread - This is the standard screw for Pocket-Screw Joinery in softer materials such as pine, plywood, particle board, MDF and melamine. Larger diameter threads provide maximum holding power while the washer head seats flushly in the bottom of the pocket, eliminating any chance of pull through.

Part #	Description	100	500	1,000	5,000
#SML-C1	#8, coarse thread, 1"	\$3.99	\$14.99	\$22.49	\$64.99
#SML-C125	#8, coarse thread, 1-1/4"	\$4.25	\$15.99	\$23.99	\$69.99
#SML-C150	#8, coarse thread, 1-1/2"	\$4.49	\$16.99	\$24.99	\$74.99
			50	250	3,000
#SML-C2	#8, coarse thread, 2"		\$2.99	\$11.20	\$59.99
			50	250	2,000
#SML-C250	#8, coarse thread, 2-1/2"		\$3.33	\$12.49	\$44.99

Maxi-Loc™ Hi-Lo

Maxi-Loc™ Hi-Lo Threads – This dual thread design is as close as we come to an all purpose screw and works well in a wide variety of wood species. This screw drives significantly faster than a standard fine or coarse thread screw because of the presence of two separate threads on the screw body.

Part #	Description	100	500	1,000	5,000
#SML-HL125	#7, Hi-Lo thread 1-1/4"	\$4.25	\$15.99	\$23.99	\$69.99

Pan Head Fine

Pan Head Screws - The fine thread version of this screw is very popular for producing face frames with hardwoods. Choose from either the 1-1/4" or 1-1/2" screw to join 3/4" thick frames. The coarse thread 1" screw (SPS-C1) is the recommended screw for assembling 1/2" plywood drawer boxes.

Part #	Description	100	500	1,000	5,000
#SPS-F1	#6, fine thread, 1"	\$3.99	\$14.99	\$22.49	\$64.99
#SPS-C1	#7, coarse thread, 1"	\$3.99	\$14.99	\$22.49	\$64.99
#SPS-F125	#6, fine thread, 1-1/4"	\$4.25	\$15.99	\$23.99	\$69.99
#SPS-F150	#6, fine thread, 1-1/2"	\$4.49	\$16.99	\$24.99	\$74.99

Pan Head Coarse



Weather Resistant Self-Tapping Screws



Blue-Kote™ is the next generation of rust-resistant screw and the best choice in the majority of Pocket-Screw applications. Through an extensive process which chemically combines three special anti-corrosion layers, Blue-Kote™ screws take on amazing new rust-resistant properties which are consistently rated 400% higher than our old zinc-plated screws.

Part #	Description	100	1,000	5,000
#SML-C125B	#8, coarse thread, 1-1/4"	\$6.38	\$35.99	\$104.99
#SML-C150B	#8, coarse thread, 1-1/2"	\$6.75	\$37.49	\$112.99
		50	250	3,000
#SML-C2B	#8, coarse thread, 2"	\$4.49	\$16.80	\$89.99
		50	250	2,000
#SML-C250B	#8, coarse thread, 2-1/2"	\$4.99	\$18.75	\$67.99

Stainless Screws - Specially designed for maritime applications, excessive exposure to salt water, and other exceedingly corrosive environments such as ACQ treated lumber.

Part #	Description	100	1,000	5,000
#SML-C125S5	#8, coarse thread, 1-1/4"	\$17.99	\$119.99	\$369.99
#SML-F125S5	#8, fine thread, 1-1/4"	\$18.99	\$124.99	\$389.99
#SML-C150S5	#8, coarse thread, 1-1/2"	\$19.99	\$129.99	\$399.99
		50	250	2,000
#SML-C250S5	#8, coarse thread, 2-1/2"	\$24.99	\$99.99	\$399.99



Screw Kit

This kit contains five of our most popular self-tapping screw sizes for Pocket-Screw Joinery. Use a 1" screw in 1/2" material, a 1-1/4" screw in 3/4" material and a 2-1/2" screw in 1-1/2" thick material. Kit contains a total of 675 screws.

- 150 each of: SPS-F1, SPS-C1, SML-F125, SML-C125
- 75 pieces of: SML-C250W

ITEM# SK02
\$29⁹⁹

Pocket-Hole Plugs













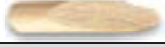

Drill Bits / Driver Bits



Conceal your Pocket-Holes

For those times when Pocket-Holes won't be hidden on the backside of your project or you want to highlight them decoratively, use our Pocket-Hole Plugs. Plugs are offered in 7 solid wood species, and 5 plastic cap colors for use on laminated surfaces.

Solid Wood Plugs		50 ct.	1,000 ct.
A. #P-MAP		MAPLE	\$6.99 \$109.99
B. #P-WAL		WALNUT	\$6.99 \$109.99
C. #P-OAK		OAK	\$6.99 \$109.99
D. #P-PIN		PINE	\$6.99 \$109.99
E. #P-CHE		CHERRY	\$6.99 \$109.99
F. #P-BAS		BASSWOOD	\$6.99 \$109.99
G. #P-CDR		CEDAR	\$6.99 \$109.99
H. #P-PNT		PAINT GRADE	\$4.99 \$79.99

Plastic Caps		50 ct.	1,000 ct.
#C-BRN		BROWN	\$7.99 \$124.99
#C-BLK		BLACK	\$7.99 \$124.99
#C-WHT		WHITE	\$7.99 \$124.99
#C-ALM		ALMOND	\$7.99 \$124.99
#C-LTB		LIGHT BROWN	\$7.99 \$124.99

Drill Bits

Our one-piece design eliminates clogging and provides a much smoother and faster drilling stroke than the drill bits with replaceable center drills. The KJD bit for our manual Pocket-Hole Jigs is made of high-speed steel while the DKDB machine bit is made of cobalt steel that increases the bit's life. Because the DKDB bit is also 3/8" diameter it can be used in any of our manual jigs as a premium replacement. Be sure to order the left hand drill bit (LH-DKDB) for the center spindle of the DK3100 fully-automatic machine.

- A. **#DKDB** For DK1100, DK3100, DK5100 and Foreman **\$29.99**
- B. **#LH-DKDB** For DK3100 Center Spindle (Left Hand) **\$34.99**
- C. **#KJD** For Mini, R3, K2, K2000 & K3 **\$16.99**
- D. **#KJSC/D** Depth Collar and Allen Wrench **\$2.25**



Drivers

Deep #2 Driver recess resists cam-out and comes in either 3" or 6" lengths. The 6" length is easier to use in the majority of applications, but the 3" works great in tight spots.

- E. **#D3** 3", #2 Square Driver **\$1.75**
- F. **#D6** 6", #2 Square Driver **\$2.75**
- #DDS** 3" & 6", #2 Square Driver Set **\$4.49**
- #D6X2** (2) - 6", #2 Square Driver Set **\$5.49**

Drill Bit Sharpening Service

Dull drill bits run hot which shortens their lives. We'll sharpen them for a fraction of the cost of a new one. Charge is \$4 per bit in the continental U.S. and \$6 per bit in Canada, Alaska, Hawaii and Puerto Rico.

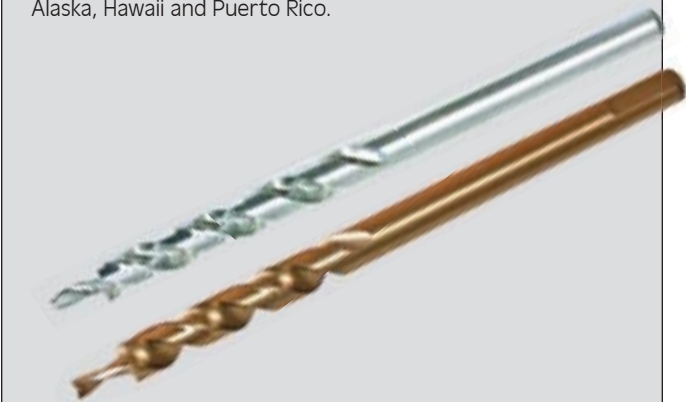

- #SHARP US** Sharpen One Drill Bit **\$4.00**
- #SHARP CAN** Sharpen One Drill Bit **\$6.00**
- Each Additional Bit **\$2.00**

Precision Router Table

After an extensive design and development process, we're very proud to announce the launch of our newest product, the Kreg Precision Router Table. Coming off the success of our Precision Measuring product line, our customers wanted us to bring the same precision and accuracy we had brought to their tablesaw and band saw, to their router table. Through a series of ground-breaking new features, including the innovative self-squaring t-square style fence, the fully enclosed tubular aluminum extrusion, and the steel-strut reinforced MDF top with its Easy-Slide™ Micro-Dot skin, just to name a few... the table is set to make a real name for itself in the industry.

It's a new age in routing equipment, and we're excited to be leading the way. Please read on, and discover all of the new features for yourself.

NEW

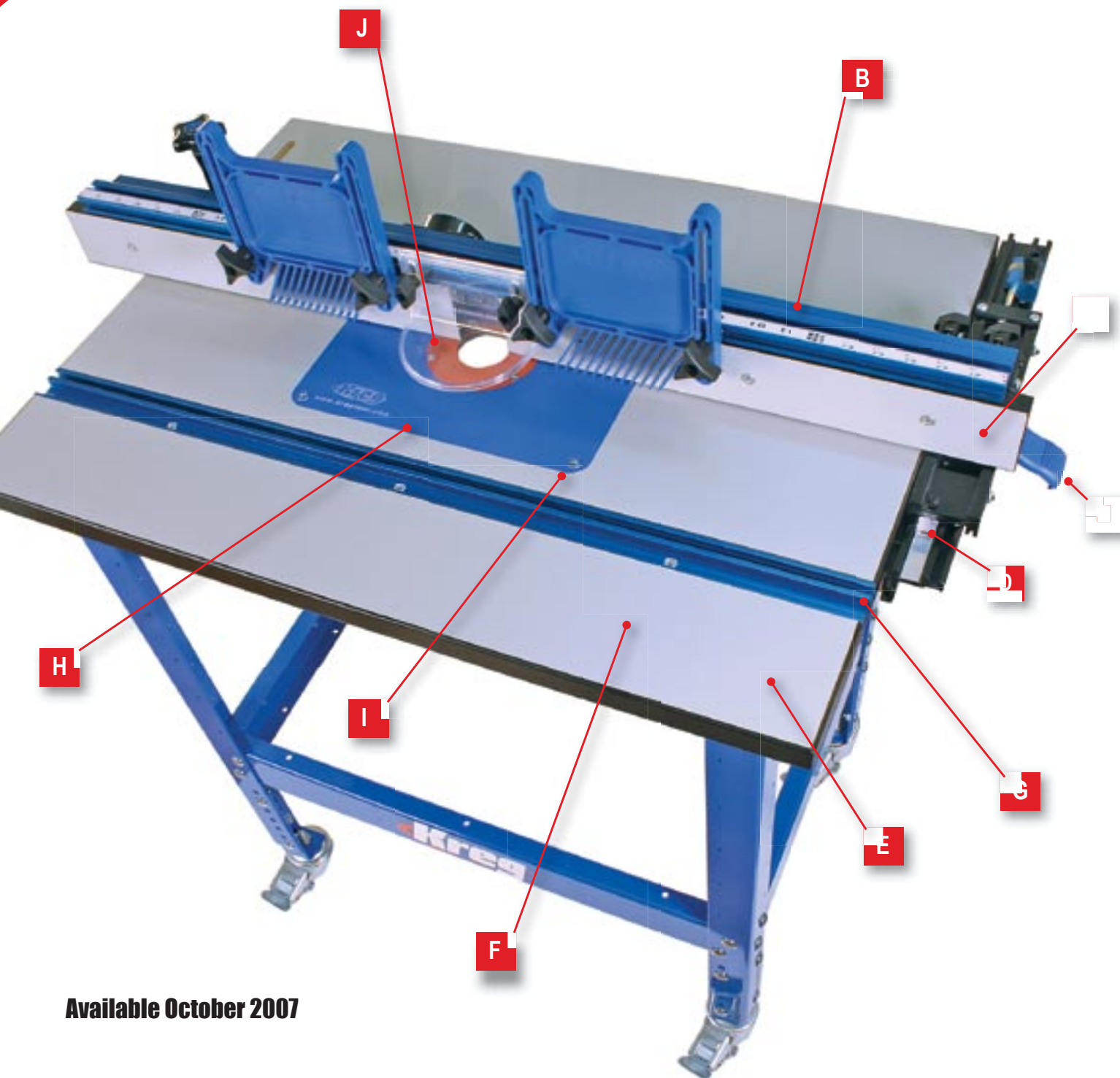

Available October 2007

FENCE

A TABLE SAW FUNDAMENTALS

Unique self-squaring t-square style fence design – similar to those found on high-end table saw rip fences – allows the fence to be quickly and accurately adjusted parallel to the miter slot. Unique cam-style locking handle and opposite-side anchor ensures incredible fence rigidity.

B HEAVY-DUTY ALUMINUM DESIGN

Fully enclosed heavy-duty aluminum extrusion provides unmatched rigidity, strength, and precision to your router top and helps to maintain an enclosed vacuum chamber for superior dust collection.

C BUILT IN JOINTER

Two fully independent fence faces and dual acrylic depth setting rods quickly turn your router table into a vertical jointer. Depth rods are stored inside of the fence and can be added behind the faces to allow for jointing depth adjustments of 1/16" and 1/32".

D UNPARALLELED PRECISION

Magnified Precision Lens Cursor lets you forget about using a tape measure and pencil, and start getting real accuracy out of your router table. The optional Micro-Adjuster allows you to dial down your precision even further.



TABLE-TOP

E EASY-SLIDE™ MICRO-DOT MDF

The professionally edgebanded MDF top absorbs vibration and noise like no phenolic top can. It features an Easy-Slide™ Micro-Dot skin – made from an impact resistant high-pressure laminate – which makes it incredibly easy to slide workpieces across the surface.

F STARTS FLAT, STAYS FLAT

Because of the rugged MDF top and extremely rigid dual steel struts which support the center of the router table, you'll never have to worry about the table bending and bowing over time... no matter how big your router and lift may be.

G COMBINATION MITER / T-SLOT

Combination Miter/T-Slot is located precisely parallel to the router fence, which makes it easier than ever to utilize various accessories such as the Kreg Precision Miter Gauge and Kreg True-FLEX™ Featherboards.

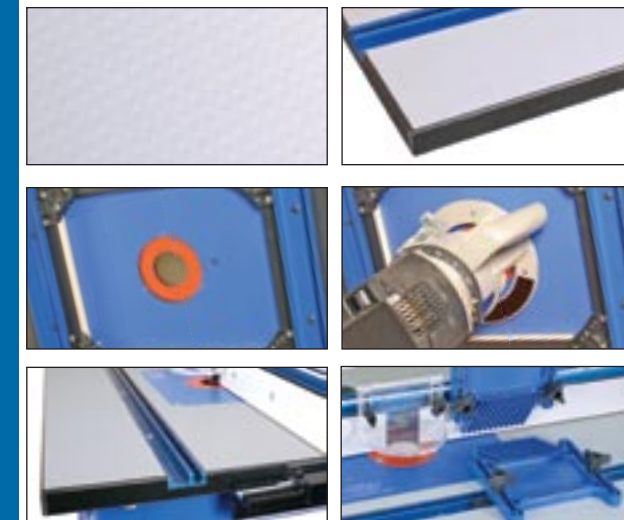

INSERT PLATE

H WORKS WITH ANY ROUTER

This 9-1/4" x 11-3/4" x 3/8" phenolic insert plate has been designed to easily mount to any router, utilizing your router's base plate and a simple (included) template. This 'swiss-cheese' free design eliminates hang-ups on the plate surface and reduces routing inconsistencies.

I UNIQUE BOTTOM-UP LEVELERS

These unique levelers feature a new bottom-mount design, 8 adjustable points of contact for leveling precision, four-corner lock-downs for stability, and locating-tabs for easy installation.

J VERSATILE REDUCING RINGS

Dual reducing rings (2", 1-1/8") boast three independent leveling/lock-down screws and compatibility with standard Porter Cable guide bushings for fast and easy template routing on your router table.

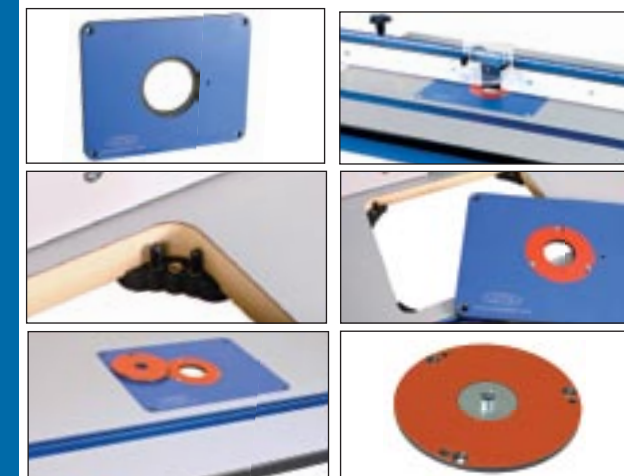

Precision Router Table Insert Plate

This rugged 3/8" phenolic plate was designed to accept nearly any router, without the use of a "swiss-cheese" style pre-drilled surface. It features an exclusive bottom-up mounting design which makes it easier than ever to get a solid, secure, and 100% level routing surface, along with dual reducing rings (2" and 1-13/64") which bring template routing to your table top through compatibility with standard Porter Cable guide bushings. It's a professional router table insert plate, designed for individuals who can truly tell the difference.



Extremely flat surface with no "swiss cheese" pre-drilled holes.

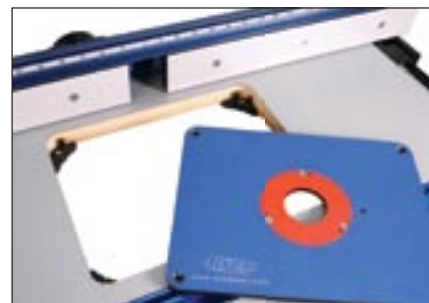

Bottom-up levelers create an incredibly solid, secure, and level surface.



1-13/64" ring is compatible with common Porter-Cable guide bushings.



ITEM# PRS3030
\$69⁹⁹

True-FLEX™ Feather Board

The True-FLEX™ Feather Board gets its name from the careful engineering that went into its design. Many featherboards on the market today apply too much pressure or not enough pressure to the workpiece, resulting in imperfect cuts and less than safe operation. We've designed each finger of the True-FLEX™ featherboard to provide a consistent and optimum pressure, and to stand up to years of use in your workshop. The featherboard is made from an extremely durable plastic composite body and even includes an exclusive wedge-lock system which allows the featherboard to be secured to a variety of shop tools without the need for additional hardware. Whether you're using a miter-slot or a t-slot, working on a table saw or a router table, the wedge-lock system adjusts accordingly and lets you work with confidence.

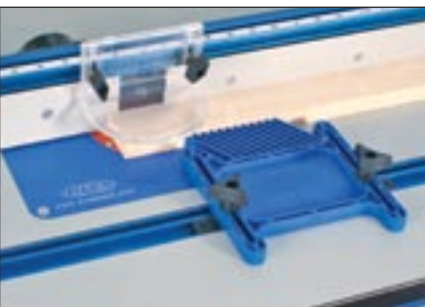

Carefully designed fingers apply optimum pressure to each workpiece.



Vertical and horizontal positioning demonstrates wedge-lock miter slot and t-slot compatibility.



Unique wedge-lock hardware works in miter slots on tablesaws, router tables, band saws and more.



Featherboard Availability



True-FLEX™ Featherboard
Single featherboard. Comes with wedge-lock hardware which works in t-slots or miter slots on tablesaws, router tables, band saws and more.

ITEM# PRS3010

\$19⁹⁹



Double True-FLEX™ Featherboard
This set of K-FLEX Featherboards comes with an extended version of the wedge-lock hardware for use in tandem. When used together they provide additional support for taller workpieces, resulting in faster, safer, and higher quality cuts.

ITEM# PRS3020

\$36⁹⁹

Precision Router Table

This revolutionary router table boasts an incredible feature-set and brings a whole new level of rigidity and precision to your woodshop.

- Fully-enclosed aluminum fence
- Self-squaring T-Square Style Fence
- Doubles as a Vertical Jointer
- Precision Lens Cursor
- Professionally Edgebanded MDF Top
- Easy-Slide™ Micro-Dot Skin
- Phenolic Insert Plate
- Unique Bottom-Up Levelers
- Dual Reducing Rings
- Porter Cable Guide Bushing Compatibility

ITEM# PRS1040

\$529⁹⁹



Precision Router Table Top

Designed to reduce vibration and noise wherever possible, this heavy-duty router table top provides a solid, secure, and quiet routing solution for any workshop.

- Professionally Edgebanded MDF Top
- Easy-Slide™ Micro-Dot Skin
- Dual Steel Support-Struts
- Heavy-Duty Construction Supports the Largest Routers and Lifts
- Combination Miter/T-Slot
- Dual Reducing Rings
- Unique Bottom-Up Levelers
- Phenolic Insert Plate
- Porter Cable Guide Bushing Compatibility

ITEM# PRS1020

\$179⁹⁹



Precision Router Table Fence

Taking design cues from high-end table saw rip fences, this groundbreaking router fence provides an entirely new way to work. It'll make every project you start faster, easier, and far more precise than ever before.

- Fully Independent Fence Faces For Use as a Vertical Jointer
- Precision Lens Cursor
- Micro-Adjuster Compatible
- Universal Mounting Design For Tables Between 3/4" and 1-1/2" Thick
- Self-Squaring T-Square Style Design
- Full-Length Vacuum Chamber
- Cam-Style Lock Down
- Fully-Enclosed Tubular Aluminum Extrusion

ITEM# PRS1010

\$199⁹⁹



Universal Steel Stand Availability

The perfect foundation for all Kreg Table Top Solutions. Includes 4 leveling feet and assembly hardware. Made from a durable heavy-gauge steel. Adjustable from 31" to 36" in height. Add Kreg Heavy-Duty Casters for additional mobility.

ITEM# KRS1030

\$149⁹⁹



Router Table Accessories

Precision Router Insert Plate Levelers



These unique levelers are the easiest way to add an insert plate to your shop-built router table. They eliminate the need for a supporting rabbet and feature a unique bottom-mount design which includes 8 adjustable points of contact, four-corner lock-downs for stability, and locating tabs for easy installation.

ITEM# PRS3040

\$19⁹⁹



Micro-Adjuster

Do you need even more precision? When added to the Precision Router Table Fence, this Micro-Adjuster allows you to dial down your measurements much further than you'd probably ever need to!

ITEM# KMS7215

\$14⁹⁹



Heavy-Duty Casters

Add true mobility to your Universal Steel Stand with our Heavy-Duty Casters. Built to last and perform, these casters feature a dual locking mechanism that won't roll OR pivot once engaged, resulting in an extremely stable work station.

ITEM# PRS3090

\$59⁹⁹

Precision Benchtop Router Table



Benchtop Portability. Floor-Standing Features.

Built from the ground-up as the portable solution to true precision routing, this table provides trim carpenters and other mobile professionals with the quality materials and attention to detail that they're only used to finding in large router tables. It features the same high pressure laminate Micro-Dot MDF surface as our top-of-the-line Precision Router Table, a full-size Phenolic insert plate, and an innovative rigid steel base which – believe it or not – actually tests quieter than enclosed portable router tables. Why put up with 'portable' features when you can have the real thing?



Light yet durable, portable yet full-featured, the perfect solution for anyone working on the road.

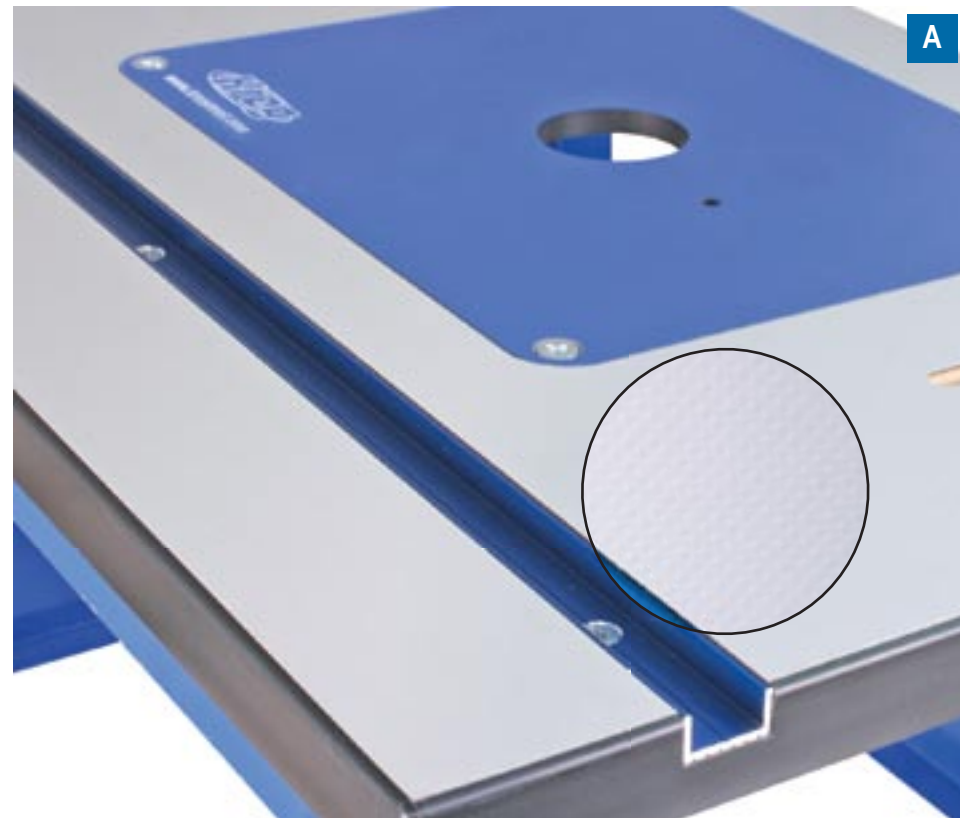

B



C



D

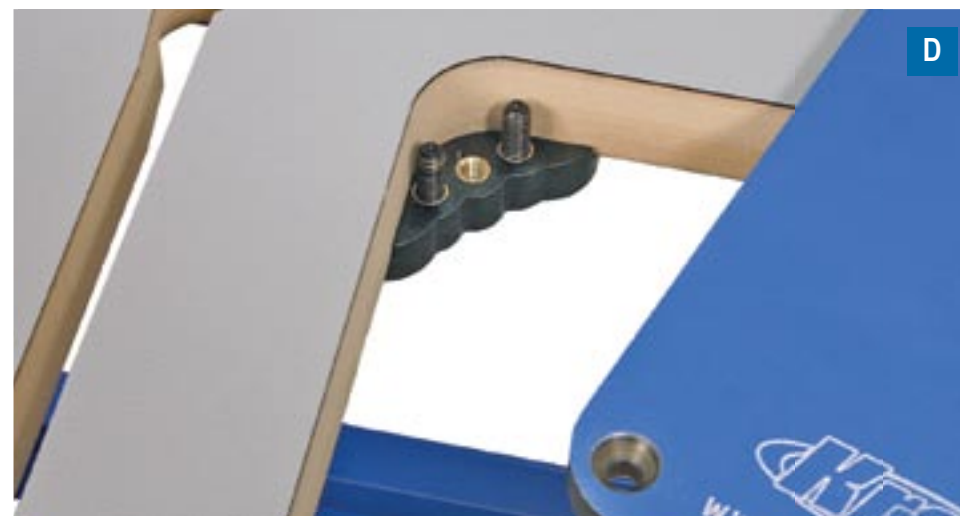

NEW
Available October 2007

Precision Benchtop Router Table Availability



Precision Benchtop Router Table

The portable solution to true precision routing. Includes fence, top, stand, plate with 2" opening.

ITEM#PRS2000

\$229⁹⁹

Precision Benchtop Router Table Accessories



True-FLEX Featherboard

This unique featherboard can be quickly and easily connected to a miter slot or t-slot without the need for additional hardware. A durable plastic composite body ensures optimum 'finger flex' and workpiece pressure.

ITEM# PRS3010

\$19⁹⁹

Precision Router Table Insert Plate

Using bits larger than 2"? This 3/8" phenolic plate provides hole openings of 3-5/8", 2", and 1-13/64". It was designed to accept nearly any router, and features unique bottom-up mounting hardware, dual reducing rings, and compatibility with standard Porter-Cable guide bushings.

ITEM# PRS3030

\$69⁹⁹

SPECIFICATIONS

- **Insert Plate Dimensions:**
9-1/4" x 11-3/4" x 3/8" with 2" opening
- **Insert Plate Material:**
Phenolic
- **Table Surface:**
16" x 24" x 1"
- **Fence Length:**
24"
- **Fence material:**
Aircraft grade Aluminum
Anodized for easy cleanup
- **Overall Dimension:**
(H x W x D)
20" x 28-1/4" x 20-1/4"
- **Weight:**
26 lbs.

A EASY-SLIDE™ MICRO-DOT MDF

Why deal with vibration and noise when you don't have to? This top features an Easy-Slide™ Micro-Dot skin – made from an impact resistant high-pressure laminate – which makes it incredibly easy to slide workpieces across the surface.

B BUILT FOR MOBILE PROFESSIONALS

This table was built to withstand years of use and abuse on the jobsite. It features a rugged stamped-steel foundation, four hard-wearing rubber feet, a professionally edgebanded table-top with an impact resistant Micro-Dot surface, and an incredibly accurate rigid aluminum fence, all built with mobile professionals in mind.

C BUILT-IN JOINTER

Fully independent fence faces and acrylic depth setting rods quickly turn your router table into a vertical jointer. Depth rods are stored on the rugged aluminum fence and can be added behind the faces to allow for jointing depth adjustments of 1/16" and 1/32".

D PHENOLIC INSERT PLATE

This full sized phenolic insert plate is held in place by our exclusive bottom-up levelers which feature 4 lock-downs – a must on the job site – and 8 adjustable points of contact for the most level surface possible. It features compatibility with an endless list of routers while omitting the usual 'swiss-cheese' pre-drilled top surface which can cause routing inconsistencies.

Precision Miter Gauge

Amazing Precision. Right Out Of The Box.

Why spend your time calibrating a miter gauge when you can get factory-milled accuracy right out of the box? Our Precision Miter Gauge System requires no calibrating, and features positive stops at 0, 10, 22-1/2, 30 and 45 degrees to make it easy to cut perfect miters quickly. Of course, when you do want to cut a more complicated angle, the easy-to-use Vernier scale allows for fast adjustments to 1/10th of a degree.



Vernier Scale adjusts to 1/10th of a degree.

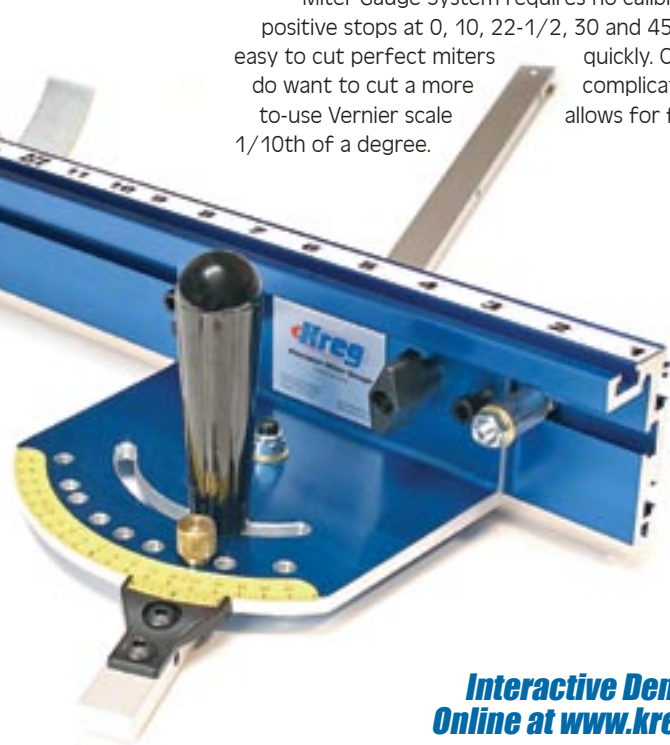

Interactive Demo Available
Online at www.kregtool.com

Perfect Miters Fast!

Precision is the name of the game for this CNC milled miter gauge. We worked hard to build accuracy into every feature of this product from the rugged aluminum fence, to the solid, yet versatile Flipstop, to the easy-to-adjust Vernier scale. Bottom line, this miter gauge will put your projects on the fast track to perfection!



Precision Miter Gauge Availability



Precision Miter Gauge System
Precision Miter Gauge, 24" fence, and Flipstop.

ITEM# KMS7102
\$159⁹⁹



Precision Miter Gauge
Precision Miter Gauge only.

ITEM# KMS7101
\$109⁹⁹

Precision Miter Gauge Accessories



Precision Miter Gauge Fence
Add the 24" fence and patented Flipstop to your miter gauge.

ITEM# KMS7103
\$59⁹⁹



Flipstop
Uniquely designed to flip out of the way when workpieces are pressed into its face.

ITEM# KMS7801
\$29⁹⁹

SPECIFICATIONS

- **Fence:**
24" aircraft grade aluminum fence
- **T-Slot bar:**
24" long, 3/8" tall x 3/4" wide
- **Positive Stops at:**
0, 10, 22-1/2, 30 & 45 degrees
- **Vernier Scale:**
Adjusts to 1/10th degree
- **Finish:**
Anodized for easy clean-up
- **Calibration:**
Factory calibrated right out of the box
- **Weight:**
6.5 lbs.

Covered by one or more of the following patents:
#5,768,966 #6,880,442 #D471,925 #5,337,641 #5,617,909
Other patents pending.



A



B

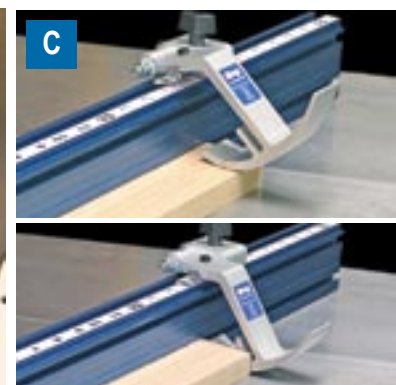

C



D

A PRECISION LENS CURSOR

Similar to the type of lens found on a quality tablesaw rip fence, the clear lens features a high-visibility red line that makes it easy to set the Flipstop for precise cuts, time after time.

B NO PLAY IN THE MITER SLOT

Our extremely straight 24" anodized aluminum bar is 3/8" tall by 3/4" wide and features five bar adjusters that eliminate "play" in the miter slot with the turn of a screw driver.

C FLIPSTOP

The Flipstop slides effortlessly along the fence of the Precision Miter Gauge and locks securely into place with the simple turn of a knob. It also features a patented curved foot that lifts out of the way when you slide a board into it, so squaring an end and cutting to length doesn't require moving the stop.

D ADD A SACRIFICIAL FENCE

The curved foot of the Flipstop's "break-away" design allows you add a sacrificial fence to your Miter Gauge.

Precision Band Saw Fence



Compensate for blade drift by loosening two hex bolts and adjusting the angle of the fence.



Add a stop to the fence for producing cuts to a repeatable depth, such as cutting tenons.

Beat Blade Drift. True Band Saw Precision.

Most band saw blades don't run perfectly perpendicular to the front of your table. There's always just a little bit of "drift" that prevents you from getting precise cuts even with a fence. Until now. Our Precision Band Saw Fence easily adjusts to your blade's drift angle to provide you with a whole new level of band saw accuracy. This fence mounts to most 14" band saws right out of the box and can be modified to fit many others by drilling a single hole in the aluminum mounting rail.

Interactive Demo Available
Online at www.kregtool.com

Precision Band Saw Fence Availability



Precision Band Saw Fence

Mounts to many 14" Band Saws right out of the box.

ITEM# KMS7200

\$119⁹⁹

Precision Band Saw Fence Accessories



Precision Micro-Adjuster

Add enhanced adjustability with our micro-adjuster.

ITEM# KMS7215

\$14⁹⁹



4.5" Resaw Guide

Adjust for blade drift on the fly with our resaw guides.

ITEM# KMS7213

\$17⁹⁹



7" Resaw Guide

Adjust for blade drift on the fly with our resaw guides.

ITEM# KMS7214

\$19⁹⁹

SPECIFICATIONS

- **Fence:**
Aircraft grade aluminum
- **Precision Lens Cursor:**
For making precise cuts
- **Blade Drift:**
Two simple adjustments for blade drift
- **Dimensions:**
Mounting Rail is 26" long
Fence is 18" long
- **Finish:**
Anodized for easy clean-up
- **Weight:**
8.75 lbs.
- **Adapability:**
Pre-drilled holes on the mounting rail for fit on most 14" Band Saws

Covered by the following patent:
#5,768,966 Other patents pending.

Unmatched Versatility...

Never before has a band saw fence allowed you to accomplish such a wide variety of cuts. This fence adjusts both for blade drift and for perpendicularity to the blade (essential when cutting thin veneers). In addition, the fence can be removed and reassembled in a low-profile position to allow the blade guard to be moved closer to the workpiece. Last but not least, the fence can accept resaw guides or our stops for use in additional applications.

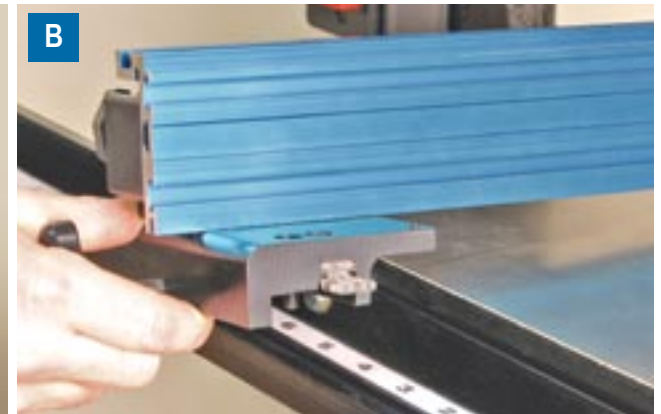
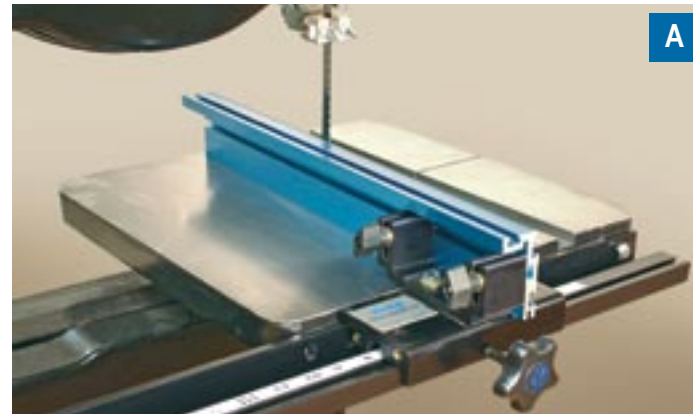

A RIGID DESIGN

The aluminum fence is incredibly strong, straight and built to last for years to come. The face and topside of the fence contains t-slots for adding stops, resaw guides and more.

B EASY TO REMOVE

When you don't need the fence, remove it in seconds - no tools required! Just loosen the locking knob and lift the fence from the mounting rail, which is below your table's surface and won't interfere with your miter slot.

C PRECISION LENS CURSOR

Magnified and easy-to-read for even the smallest adjustments, the thin red line on the Precision Lens Cursor lets you accurately set up the fence for cutting veneer, tenons and more.

D ADJUSTABLE IN 2 DIMENSIONS

This fence is unique in that it adjusts to set up perfectly square to your table and blade. Two simple adjustments allow you to set the fence to match blade drift, greatly enhancing cutting accuracy.

Precision Trak & Stop Kit



**No Tape Measure. No Pencil.
Just Precision.**

Take the guesswork — and your tape measure and pencil — out of cutting wood to length. Our Precision Measuring Systems Kit allows you to turn your shop miter saw into a precise cutting system. Simply slide the cursor of the stop to the dimension you'd like to cut, place the board against the stop, and cut to an exact length time after time. You build the support wings yourself out of plywood or particle board then add the trak to the topside of the board. Perfectly sized workpieces couldn't be simpler!

**Demo Video
Available Online**

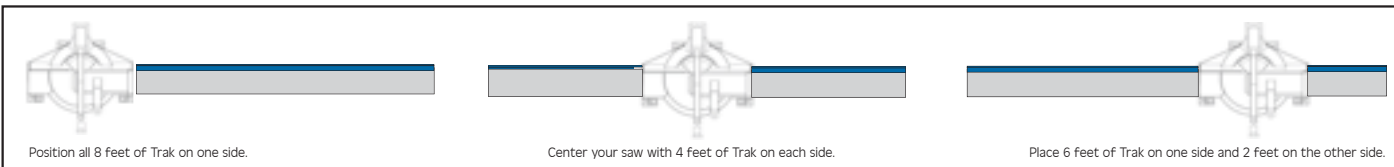

Precision Trak and Stop Availability



Precision Trak and Stop Kit

Includes four 2' pieces of Trak, 1 Flipstop, 1 Production Stop, one 12' length of L-R reading self-adhesive tape, one 12' length of R-L reading self-adhesive tape, detailed instructions, and mounting hardware.

ITEM# KMS8000
\$139⁹⁹

Precision Trak and Stops Accessories



Miter Attachment

Easily attached to a Flipstop or Production Stop, the Miter Attachment supports the mitered end of the board on two surfaces to make a more accurate cut. Perfect for picture framers.

ITEM# KMS7831
\$19⁹⁹



Top Trak 4'

Add additional trak to your Trak and Stop Kit.

ITEM# KMS7714
\$34⁹⁹



Flipstop

Uniquely designed to flip out of the way when workpieces are pressed into its face.

ITEM# KMS7801
\$29⁹⁹



Production Stop

Features dual lens cursors and the unique ability to be quickly moved to either side of the saw.

ITEM# KMS7800
\$19⁹⁹

SPECIFICATIONS

- **Fence:**
Aircraft grade aluminum
- **Finish:**
Anodized for easy clean-up
- **Cutting Capacity:**
96" minimum
- **Weight:**
7 lbs.
- **Length:**
(4) 2' sections for 8' of Trak length
- **Measuring Tape:**
(1) 12' R to L Reading
(1) 12' L to R Reading

Covered by one or more of the following patents:
#5,768,966 #6,880,442 #D471,925 #5,337,641
Other patents pending.

Perfect for a Variety of Applications

The most common setup for the Precision Measuring Systems Kit is with a miter saw, but many woodworkers find it handy to add to their radial arm saw or drill press. No matter where you use the Precision Measuring Systems Kit, you'll find it remarkably more fast and accurate than a tape measure and pencil.



A PRODUCTION STOP

Designed to stand up to the rigors of repetitive cuts in an industrial environment, the Production Stop drops onto the top of the fence and features dual lens cursors for convenient use on either side of the blade.

B FLIPSTOP

The patented design of the Flipstop gives you a precise measurement when you need it and flips out of the way when you don't by simply pushing a board into the curved face of the stop. Like the Production Stop, it features the Precision Lens Cursor for fast, pinpoint positioning.

C SHOP MADE SUPPORT WINGS

Build a simple plywood or MDF box to match the height of your saw, then add a back fence that reaches 2-1/4" above the saw height for the stops to glide upon. Instructions and mounting hardware for the Trak are included.

D RIDGID ALUMINUM FENCE

Incredibly strong and built to last, our anodized aluminum Trak features an L-shaped foot that makes alignment and mounting to any 3/4" thick board a snap. Trak is designed with a groove across the top to accept the included self-adhesive measuring tape.

Precision Stops

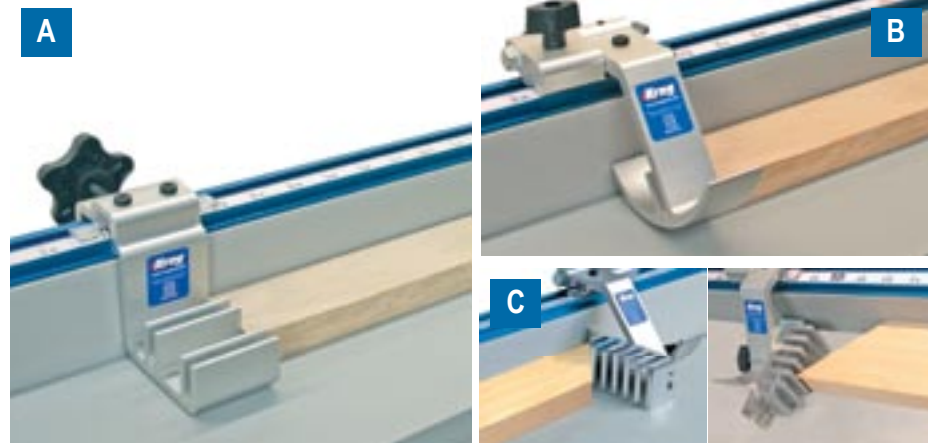
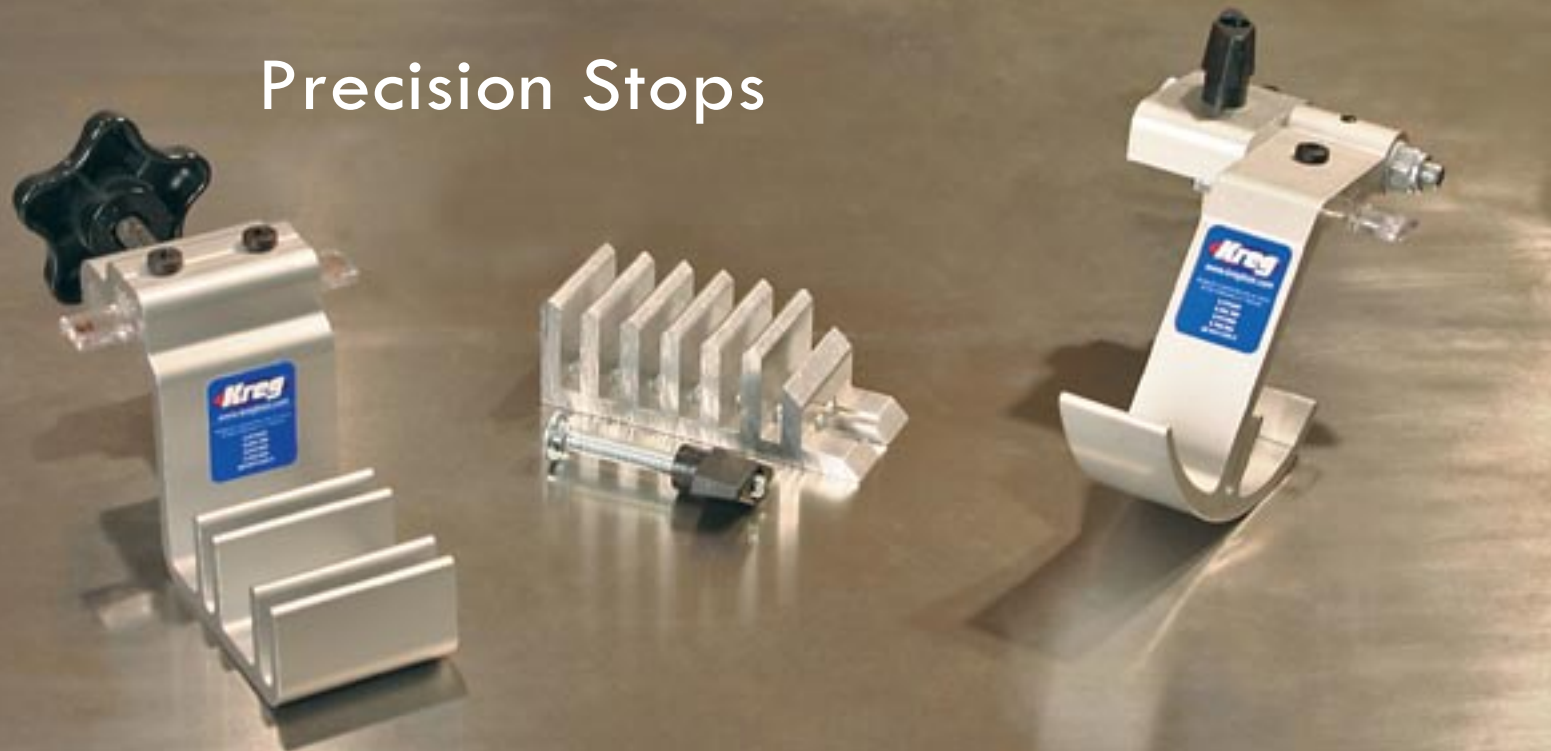

Kreg Precision Stops Availability



Flipstop

Uniquely designed to flip out of the way when workpieces are pressed into its face.

ITEM# KMS7801
\$29⁹⁹



Production Stop

Features dual lens cursors and the unique ability to be quickly moved to either side of the saw.

ITEM# KMS7800
\$19⁹⁹



Miter Attachment

Easily attached to a Flipstop or Production Stop, the Miter Attachment supports the mitered end of the board on two surfaces to make a more accurate cut. Perfect for picture framers.

ITEM# KMS7831
\$19⁹⁹

A PRODUCTION STOP

Our Production Stop is built for a rugged shop environment. Dual lens cursors on both sides of the stop allow it to be easily used on either side of the blade without reconfiguring. This stop also drops onto both the Top Trak and Heavy Duty Trak from the topside, allowing it to be quickly removed and repositioned without sliding to the edge of the trak section.

B FLIPSTOP

Our patented Flipstop easily sets the distance between the end of the board and the saw blade for amazing cutting accuracy and repeatability. The curved design of the Flipstop allows a board to bypass the stop system by simply sliding the board into the stop, thereby lifting it out of the way. The Flipstop features an adjustable lens cursor much like that found on a high-quality tablesaw rip fence that can be "zeroed" out to assure pinpoint accuracy.

C MITER ATTACHMENT

Our "Perfect Miter" attachment is designed to support the mitered end of a board so that the sharp point of the miter is not damaged while cutting. The attachment also allows the mitered end to be measured off of two points of contact instead of the toe of the miter, creating increased accuracy. A slot is machined into the attachment which enables it to be attached to the Production Stop or Flipstop with a simple carriage bolt (included).

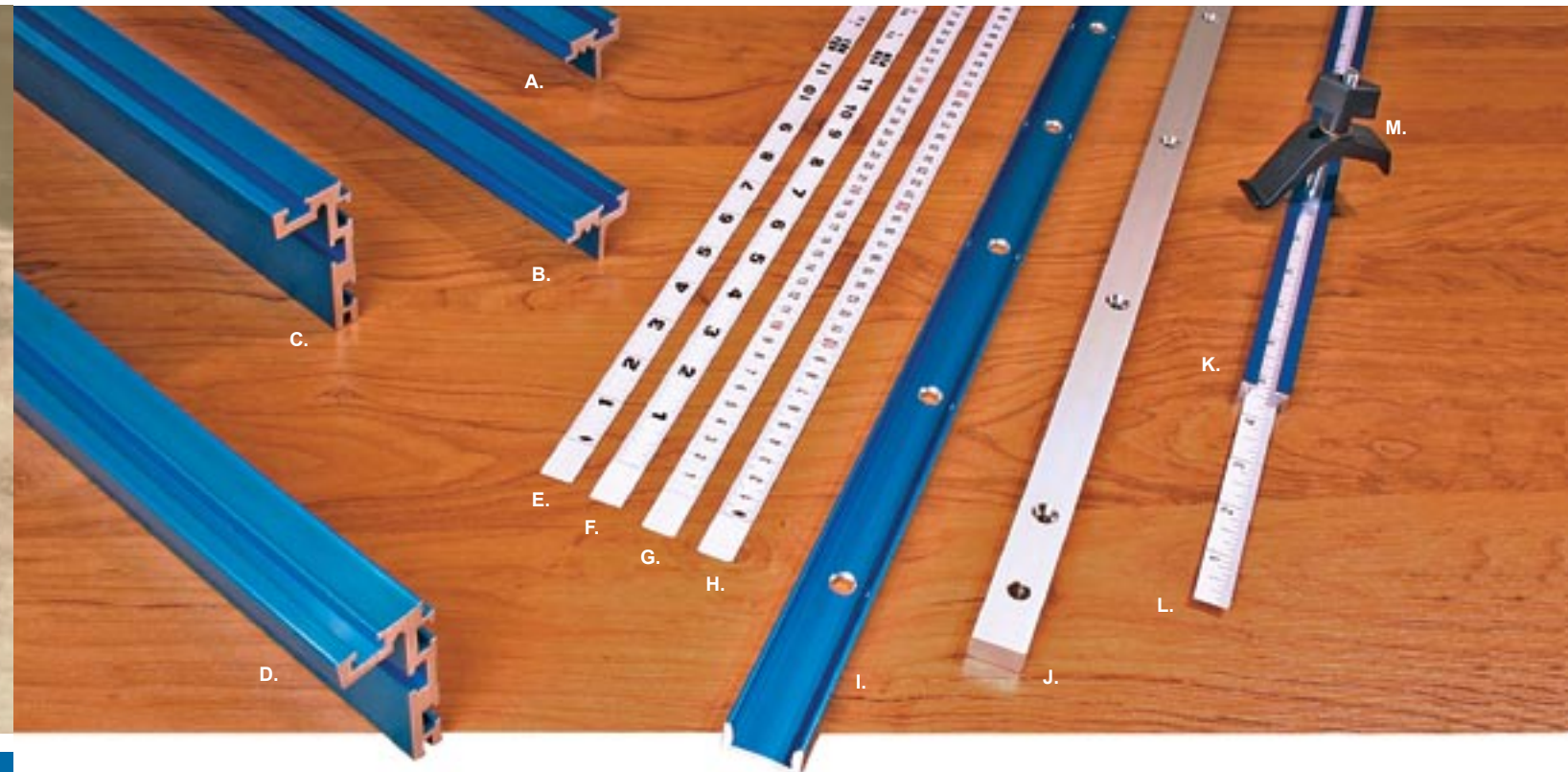

Precision Trak

Top Trak

Trak features a self-aligning L-shaped mounting foot for easy installation to a shop-made fence. Just drill 1/8" holes through the back of the extrusion and secure with the included mounting screws.

A. #KMS7712 Top Trak (2' length) **\$21⁹⁹**
B. #KMS7714 Top Trak (4' length) **\$34⁹⁹**

Heavy Duty Trak

Our Heavy Duty Trak is an L-shaped, anodized aluminum extrusion that is extremely straight and perfect for heavy use commercial applications. Contains four T-slots which accommodate the head of a standard 1/4" hex bolt. A 1/2" recessed indentation runs along the top and frontside of the trak for easy application of a self-adhesive measuring tape.

C. #KMS7702 Heavy Duty Trak (2' length) **\$39⁹⁹**
D. #KMS7704 Heavy Duty Trak (4' length) **\$59⁹⁹**

Imperial 12' Self-Adhesive Tape

This 1/2" wide, self-adhesive measuring tape fits snugly into the indentation on the topside of our Top Trak and Heavy Duty Trak. Metallic tape is highly scuff resistant and can be trimmed to length with a scissors.

E. #KMS7724 Tape (12' L-R reading) **\$7⁴⁹**
F. #KMS7723 Tape (12' R-L reading) **\$7⁴⁹**

Metric 3.5 Meter Self-Adhesive Tape

Metric 3.5 meter tape, self-adhesive and fits snugly into the indentation on the topside of our Top Trak and Heavy Duty Trak. Metallic tape is highly scuff resistant and can be trimmed to length with a scissors.

G. #KMS7728 Tape (3.5 meter R-L reading) **\$7⁴⁹**
H. #KMS7729 Tape (3.5 meter L-R reading) **\$7⁴⁹**

Adjustable Miter Trak

The weakness of most router tables is that there is no miter slot for using a miter gauge with the cutter. Our Adjustable Miter Trak provides a clever and inexpensive means of positioning a miter slot on the router table. The extrusion works with any 3/4" by 3/8" miter gauge bar.

I. #KMS7402 Adjustable Miter Trak (42") **\$24⁹⁹**

Jig and Fixture Bar

This is the same adjustable bar that comes standard on the Precision Miter Gauge. Six nylon screws along the length of the bar adjust with the turn of a screwdriver to take up any play in the miter gauge slot. Mounting holes are located every 4" along the length of the bar. Perfect for building workshop jigs and fixtures.

J. #KMS7303 Jig & Fixture Bar (30") **\$23⁹⁹**

Mini Trak

Mini Trak can be used to produce countless types of woodshop jigs and fixtures such as taper jigs, cut-off sleds, and more. An adaptation of our other popular styles of trak, Mini Trak contains t-slots that will capture the head of a standard 1/4" hex bolt. You can surface mount Mini Trak or mount it flush into a 3/8" x 3/4" dado or rabbet. This 4' section can be easily cut to length with a hacksaw. As an added feature, Mini Trak now contains a recess in the bottom of the extrusion that will receive a 1/2" measuring tape (included). Simply slide the tape into the trak and enjoy the added precision of your shop-made jigs and fixtures.

K. #KMS7506 Mini Trak (48" length with 4' tape) **\$18⁹⁹**
L. #KMS7727 Additional 4' Non-Adhesive Tape **\$ 4⁹⁹**

Trak Clamp

This inexpensive and versatile clamp works great in a variety of applications. Fits the Mini Trak, Top Trak or HD Trak. You may also mount the clamp to a piece of wood by drilling a 1/4" hole and then countersinking a 7/16" hole for the bolt head. When mounting the clamp on any of the tracks, be sure to have the base of the clamp seated on the track to avoid pulling the track out of the work surface. For most clamping applications, we suggest using two clamps to keep the work piece from rotating.

M. #KMS7511 Trak Clamp **\$4⁹⁹**

Klamp Table™

Demo Video
Available Online



The Ultimate Clamping Solution for Pocket-Screw Joinery!

You don't need an army of clamps to get the job done; you just need the right ones. Our Klamp Table™ is the ultimate 'helping hand' around the workshop and the easiest way to get perfectly flush Pocket-Screw Joints, one after another.

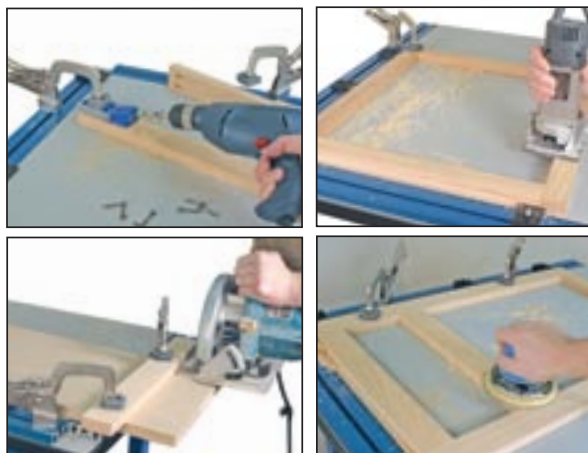

Drilling, routing, sawing, sanding... whatever you're doing, the Klamp Table™ can help make it faster and easier.



Perfect Pocket-Screw Joints. Every Time.

If you've ever struggled to get your Pocket-Screw Joints to come out perfectly straight and flush, the Klamp Table™ is an invaluable addition to your collection. While the two Bench Klamps secure each joint, the 5 individual Klamp Blocks™ allow you to quickly register your workpieces to the edge of the table, center the Bench Klamp along the joint line, and bring your entire project into alignment.

Klamp Table™ Availability



Klamp Table™/ Stand Combo

It's time you had a table that was designed with clamping as its primary focus. This is the ultimate solution for any handy-man or woodworker, and a great addition to any workshop.

Combination of Klamp Table™ and Universal Steel Stand.

ITEM# KKS2000

\$399⁹⁹



Klamp Table™

Buy the Klamp Table™ separately and use it on top of your current workbench. Includes 2 Bench Klamps, 5 Klamp Blocks™, 2 lengths of Klamp Trak™, all positioned on a durable melamine surface.

ITEM# KKS1000

\$249⁹⁹



Universal Steel Stand

The perfect foundation for all Kreg Table Top Solutions. Includes 4 leveling feet and assembly hardware. Made from heavy-gauge steel. Adjustable from 31" to 36" in height.

ITEM# KRS1030

\$149⁹⁹

Klamp Table™ Accessories



3" Dual-Locking Caster Set

Add true mobility to your Universal Steel Stand. Includes 4 Heavy-Duty casters. Dual-locking mechanism protects against caster roll and pivot.

ITEM# PRS3090

\$59⁹⁹

SPECIFICATIONS

Klamp Table:

- Large, 21-3/4" x 33-3/4", clamping surface.
- Replaceable, glue resistant, melamine surface.
- Trak on two sides of the table, provides endless flexibility.
- Klamp Blocks allow for fast, accurate, and consistent registration of workpieces.
- Multi-Function: Can be used for a variety of woodworking functions, including sanding, routing, layout, etc.

Universal Steel Stand:

- Heavy gauge steel construction
- 31" to 36" height adjustability
- 4-Stable leveling feet
- Durable painted finish
- Fast and easy assembly

Build your own.

Each Klamp System™ component can be purchased separately. Whether you need a seamless clamping plane down the edge of your current workbench or a stationary clamping station in the center of your sawhorse, you can pick the perfect Klamp System™ component, and install it yourself.

Turn the page for more information on each individual Klamp System™ component.

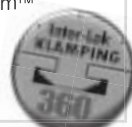

A VERSATILE CLAMPING

Are you always looking for the right clamp? The Bench Klamp™, with Inter-Lok Technology, is great for almost any woodworking task. It slides across the Klamp Trak™, rotates 360 degrees, and firmly locks into place wherever you need it most.

B FLEXIBLE POSITIONING

Stop working around your clamps and start working with them. The Klamp Trak™ allows you to position your Bench Klamp™ and Klamp Blocks™ anywhere along the table's edge, and quickly remove them to regain your flat work surface.

C PRECISE ALIGNMENT

Made from durable, impact resistant plastic, Klamp Blocks™ glide along the Klamp Trak™ allowing you to quickly register stock to the edge of your work space, and bring your entire project into alignment.

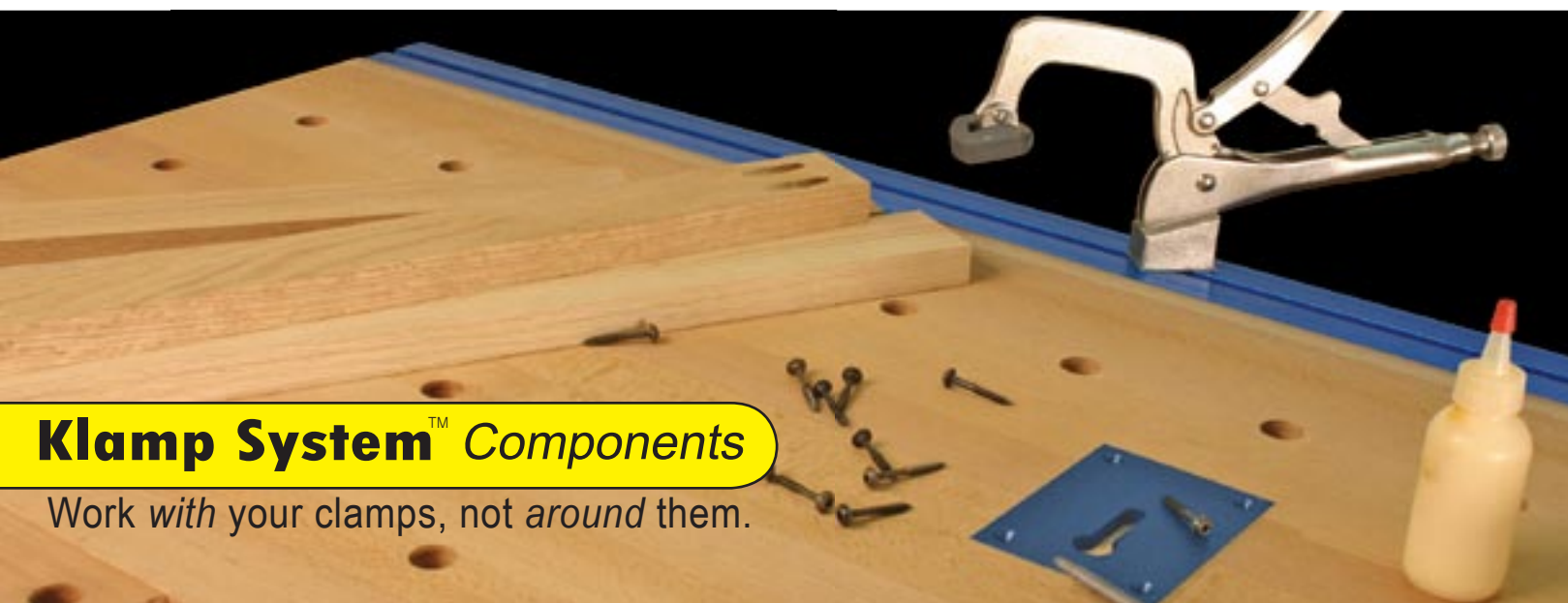

Klamp System™ Components

Work with your clamps, not around them.

Klamp System Components Availability



Bench Klamp

The most flexible clamp on the market. Includes clamp, Inter-Lok bolt, and clamp pad.

ITEM# KKS1010

\$27⁹⁹



Klamp™Plate

Add a clamping station almost anywhere. Includes plate, and mounting hardware.

ITEM# KBK-IP

\$9⁹⁹



Klamp™ Trak

Turn the entire length of your workbench into a clamping station. Includes one 33-3/4" aluminum extrusion.

ITEM# KKS1020

\$44⁹⁹

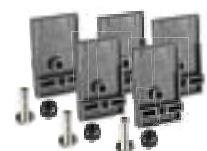

Klamp Blocks

The easiest way to quickly bring your project into alignment and center your Bench™ Klamp on the joint! ITEM# KKS1030 line. Includes 5 plastic blocks and mounting hardware.

\$14⁹⁹



Bench Klamp System

Combination of Bench Klamp™ and Klamp Plate™. Includes clamp, Inter-Lok™ bolt, clamp pad, plate, and mounting hardware.

ITEM# KBK

\$34⁹⁹



Large Bench Klamp System

Take your work on the road. Includes 10"x10"x1/4" zinc coated steel plate, clamp, mounting hardware, and rubber feet.

ITEM# KLBK

\$54⁹⁹

Designed WITH KLAMPING IN MIND.



Every wood-worker knows that the quality of their work and the time they invest in each project, are directly affected by the tools they use. Many times however, we overlook the small things; like our workbench, clamps, and measuring devices. But no more! With the Kreg Klamp System™, you'll notice an immediate difference in productivity, efficiency, and ease-of-use, which translates into real results.

Designed from the ground-up as the ultimate clamping solution for Pocket-Screw Joinery and the perfect 'helping hand' around the work shop, Kreg is proud to introduce the entire family of Klamp System™ Components. If you've ever struggled to get perfectly flush Pocket-Screw Joints, ever failed to get your clamps positioned exactly where you need them, or ever just need an extra set of hands around the work shop, this is exactly what you've been looking for.

Instead of being restrained to clamping in very specific places, Klamp System™ components let you work wherever you need to most. Utilizing a simple technology called Inter-Lok™, the Bench Klamp™ can be quickly added almost anywhere you need it, positioned precisely, rotated 360 degrees, and – just as quickly as it was added – removed to regain your perfectly flush work surface. Add a Klamp Trak™ to the edge of your workbench or add a Klamp Plate™ to the center of your workbench, and start clamping where you've never been able to before. For the very first time, you can stop working around your clamps and start working with them.

B

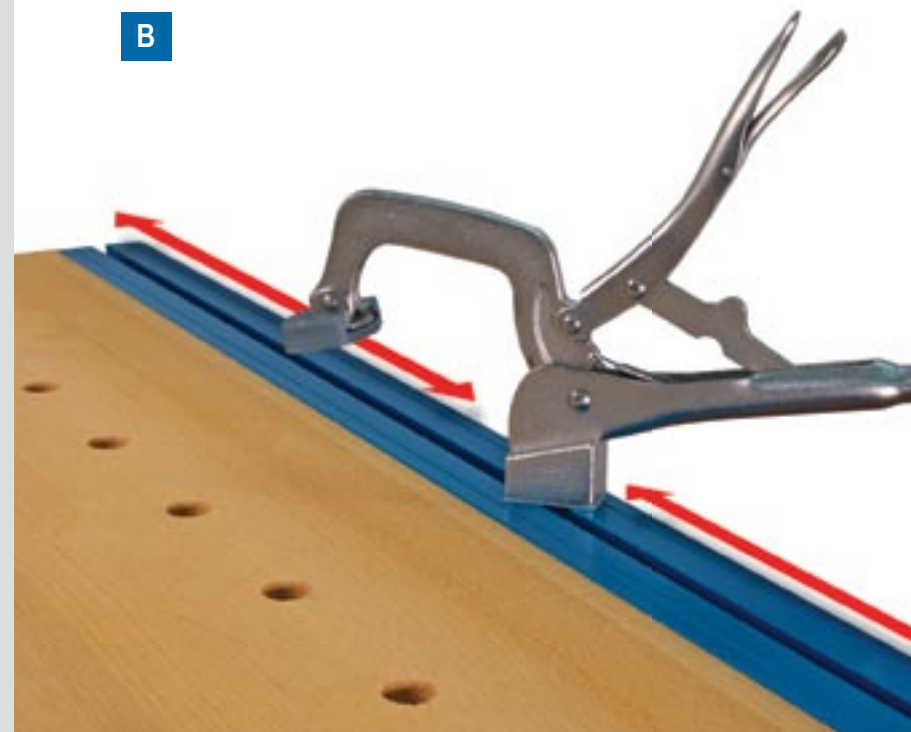

C



D



A BENCH KLAMP™

This unique clamp glides along the Klamp Trak™ or secures to the Klamp Plate™, providing an amazingly strong 360 degree clamping station, wherever you need it most. Simply remove the Bench Klamp™ to regain your perfectly flush work surface.

B KLAMP TRAK™

Turn the entire length of your workbench into a clamping station. This amazing track provides a seamless clamping plane down the edge of your work bench; perfect for quick positioning of your Bench Klamp™ and Klamp Blocks™.

C KLAMP BLOCKS™

When used with the Klamp Trak™, these simple blocks allow you to quickly and accurately register your stock to the edge of your work space and bring your entire project into alignment. Made from durable, impact resistant plastic.

D KLAMP PLATE™

Don't be satisfied with clamping on the edge of your workbench. When paired with the Bench Klamp™, this plate provides a clamping station wherever you need it most. Rout one into the center of your work bench, drill press, or sawhorse!



Inter-Lok

This Quick-Connect feature serves as the foundation for all Klamp System™ components. With it, the Bench Klamp™ can be quickly moved from place to place, providing 360 degree clamping, wherever you need it most.

Right angle Clamp



90° Clamping Made Easy

Attaching a face frame to a cabinet carcass, assembling drawers, shelving and other situations where you need to join workpieces at 90 degree angles is a snap with the Right Angle Clamp. It features a steel pin on one arm that fits snugly into one Pocket-Hole to clamp the pieces together as you drive a screw into an adjacent hole. Using the Right Angle Clamp is like having a helper on hand to hold materials at a perfect 90°.

Face Clamps™

Flush Joints, Time After Time

These dual-purpose clamps are a great way to get perfectly flush Pocket-Screw Joints and the fastest way to secure our portable Pocket-Hole Jigs.



B

A CLAMP USING THE POCKET-HOLE

The steel pin on one arm of the clamp is shaped to fit snugly into a Pocket-Hole, securely anchoring one workpiece against the other for easy assembly. Just drive a screw in an adjacent Pocket-Hole while the Right Angle Clamp holds the pieces for you.

B SWIVEL PAD

On the arm opposite the pin, this clamp features a pad capable of swiveling to adjust to the dimensions of your material, so you can count on solid clamping without a chance of the joint shifting.

C ULTRA WIDE REACH

Whether you're joining two thin drawer side for a cabinet or thicker materials to frame an outdoor project, the Right Angle Clamp opens wide to get the job done.

D USE TWO CLAMPS

Many woodworkers find it handy to use two Right Angle Clamps when assembling large workpieces. Place a clamp on each end to hold the wood while you drive screws in the remaining Pocket-Holes.

A







B

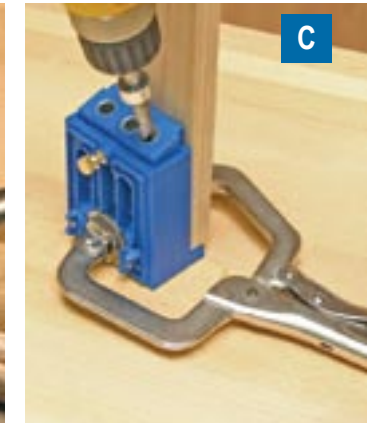

C



Kreg Face Clamps Availability

	Standard Face Clamp 2" Reach, Maximum Opening of 1-3/4"	ITEM# SFC \$14⁹⁹
	Premium Face Clamp 3-1/4" Reach, Maximum Opening of 2-3/4"	ITEM# PFC \$19⁹⁹
	Large Face Clamp 6" Reach, Maximum Opening of 5"	ITEM# LFC \$24⁹⁹
	18" Face Clamp 10" Reach, Maximum Opening of 6"	ITEM# FC18 \$34⁹⁹

A 4 SIZES TO CHOOSE FROM

We offer 4 different sizes of clamps to fit your specific application. Handle size, reach, and opening size are compared to the left.

B FLUSH JOINTS

The large pad on one arm that is placed directly across the joint line helps to create a perfectly flush joint as the screws are driven.

C DUAL PURPOSE DESIGN

Uniquely designed to both hold the joint line flush while the screws are driven, and to secure our portable Pocket-Hole Jigs into place.

Right Angle Clamp Availability



Right Angle Clamp

Steel pin, swivel pad, ultra-wide reach.

ITEM# RAC
\$24⁹⁹

Drawer Slide Mounting Tool

Put an end to trying to mount drawer slides with one hand attempting to hold the slide in place while the other hand fiddles with the drill and screws. Attaching drawer slides — bottom-mount or full-extension — perfectly parallel to the drawer opening is a snap with our Magnetic Drawer Slide Mounting Tool. The strong, rare earth magnets hold most types of metallic drawer slides in place, freeing your hands for the rest of the job. The tool includes an easy-grip handle and provides a flat surface for easy clamping. Designed to work with both face frame and faceless cabinets, the Mounting Tool features large openings in the side to give you clear access for driving screws.



ITEM# NZ03
\$29⁹⁹

Drawer Slide Mounting Brackets

For both face frame and faceless cabinets, aligning the drawer box to full-extension slides is simple with our Drawer Mounting Brackets. Simply clamp a bracket under each slide, set the drawer box into the drawer opening so it balances on the brackets, then pull the slide to the front of the box and drive your screws. The 12" brackets work with most common drawer sizes, and the 1/8" tabs on the front of bracket are designed to fit under mounted full-extension slides for perfect placement every time. Made of rugged, impact-resistant plastic for years of service, these brackets are a great addition to your workshop and toolbox.



ITEM# NZ03-B
\$9⁹⁹



Trim Carpentry DVD

Gary Striegler, a second generation homebuilder with over 25 years of hands-on experience, demonstrates some of his time proven techniques for creating classic home details that set his work apart from the competition. In this two hour DVD, watch as Gary uses the speed, strength, and simplicity of Pocket-Screw Joinery to create a variety of eye catching trim details for the home.

A. #V07-DVD Trim Carpentry \$9.99

Cabinetmaking DVD

Have you been reluctant to build your own cabinets because of the complicated joinery and time commitment involved? Well, wait no longer...Pocket-Screw Joinery provides a proven technique that will help you build your projects Faster, Stronger, Simpler and Better than you ever imagined possible! Sit back and relax as master woodworker John Sillaots, host of "In The Workshop", guides you through the basic techniques needed to create cabinets for your shop, home office or kitchen.

B. #V03-DVD Cabinetmaking \$9.99

Router Tables DVD

No workshop is complete without a sturdy router table to complete all of your shaping operations. Why not build one that will last a lifetime with plywood and the simplicity of Pocket-Screw Joinery? Seasoned woodworker John Sillaots has built a few router tables in his day and this is his best. This table features loads of storage space with large pull-out bottom drawers as well as dust-free router bit storage cavities. Last, but not least, a well thought out dust collection system pulls dust from both behind the fence and below the table to make this design one-of-a-kind.

C. #V06-DVD Router Tables \$9.99

Tables DVD

Ever thought of yourself as a furniture maker? With Pocket-Screw Joinery as its foundation this video will have you building strong, sturdy tables in a matter of hours. Sit back and relax as seasoned woodworker John Sillaots leads you through the simple steps needed to build a table that starts as a simple leg and rail design, then expands by adding a shelf and finally, pass-through drawers! Use the skills acquired in this video to produce tables for every room in the house; from end tables and coffee tables, to sofa tables, dining room tables and more...

D. #V05-DVD Tables \$9.99

Basic Cabinetmaking Booklet

This 40 page booklet covers the basics of building professional face frame cabinets with Pocket-Screw Joinery. The information in this booklet was provided as excerpts from an upcoming cabinetmaking book by Mark Duginske. The content of this booklet centers around building a single 15" wide base cabinet to help develop skills that will later allow a customer to produce an entire kitchen.

#MD-CAB01 Basic Cabinetmaking \$4.99



The New Complete Guide to the Band Saw

This comprehensive book written by well-known Band Saw expert and author Mark Duginske details the history and modern use of the "Most Important Tool In Your Shop" — the Bandsaw. And what do you know... he uses a Kreg Precision Band Saw Fence.

#BOOK-MDBSGB Band Saw Book \$19.95



Project Plans CD

All 15 of our Pocket-Screw project plans in PDF format on one CD. Print from your home computer.

#PCD Project Plans CD \$19.99



Kreg Tool Company
201 Campus Drive
Huxley, IA 50124
www.kregtool.com

PRSRT STD
U.S. Postage
PAID
Huxley, Iowa
Permit No. 16

